

RAMPART RANGE METROPOLITAN DISTRICTS NO. 4, 5, 6 & 8
JOINT DISCLOSURE TO PURCHASERS

This Joint Disclosure to Purchasers (“**Joint Disclosure to Purchasers**”), dated May 1, 2024, has been prepared by Rampart Range Metropolitan District No. 4 (“**District No. 4**” or the “**Regional District**”), Rampart Range Metropolitan District No. 5 (“**District No. 5**” or the “**Managing District**”), Rampart Range Metropolitan District No. 6 (“**District No. 6**”), and Rampart Range Metropolitan District No. 8 (“**District No. 8**” and, together with District No. 6, the “**Taxing Districts**”) (collectively, the “**Districts**” or “**East Side Districts**”), to provide prospective property owners with general information regarding the Districts and their operations. This Joint Disclosure to Purchasers supersedes and replaces that certain Joint Disclosure to Purchasers recorded on February 15, 2023 in the real property records of Douglas County, Colorado at Reception No. 2023006384. This Joint Disclosure to Purchasers is intended to provide an overview of pertinent information related to the Districts and does not purport to be comprehensive or definitive. The property being purchased may be located within the Service Area of one or more of the East Side Districts. You are encouraged to independently confirm the accuracy and completeness of all statements contained herein.

**DISTRICTS’ ORGANIZATION / SERVICE PLANS/
MILL LEVY PLEDGE AGREEMENT**

The property within the Rampart Range development is located within the boundaries of one or all of the East Side Districts. The Districts are quasi-municipal corporations and political subdivisions of the State of Colorado organized in Douglas County, City of Lone Tree (“**City**”), Colorado. The Districts operate pursuant to their respective Service Plans as approved by the City Council and as may be amended from time to time (the “**Service Plans**”) and by the powers authorized by Section 32-1-1004, of the Colorado Revised Statutes (the “**C.R.S.**”).

Each of the Districts was formed for the provision of water, street, traffic and safety, television relay and translation, transportation including regional transportation improvements, park and recreation, sanitation, and mosquito control improvements, programs, and services as defined in their Service Plans.

The Districts’ Service Plans include a description of the Districts’ powers and authority. Copies of the Districts’ Service Plans are available from the Division of Local Government in the State Department of Local Affairs.

The Regional District entered into a Mill Levy Pledge Agreement dated November 7, 2017 (the “**Pledge Agreement**”) with the City whereby the City and the Regional District agreed the boundaries of the Regional District would be modified to include all of the property within the service area of the Districts (“**East Side Property**”) and that the Regional District will impose a Contractual Debt Levy (as defined in the Pledge Agreement) against the East Side Property and pledge the Contractual Debt Levy Revenue (as defined in the Pledge Agreement) generated thereby to the City for the benefit of the East Side Property, all in accordance with the express terms of the Pledge Agreement. A copy of the Pledge Agreement may be obtained from the District Manager at the contact information below.

DISTRICT BOARD OF DIRECTORS

Each of the Districts is governed by a five-member Board of Directors. Members of the Districts' Boards must be qualified as eligible electors of each District. The Boards' regular meeting dates may be obtained from the District Manager at the contact information below.

DEBT AUTHORIZATION

Pursuant to its Service Plan, District No. 4 has no authority to incur or issue debt other than to execute and perform its obligations as set forth in the Pledge Agreement.

The amount of debt District Nos. 5, 6, and 8 shall each be permitted to issue, under their respective Service Plans, shall not exceed Five Hundred Million Dollars (\$500,000,000).

TAXES AND FEES IMPOSED ON PROPERTIES WITHIN THE DISTRICT

Ad Valorem Property Taxes

The Districts' primary source of revenue is from property taxes imposed on property within the Taxing Districts. Along with other taxing entities, the Taxing Districts certify a mill levy by December 15th of each year which determines the taxes paid by each property owner in the following year.

Debt Service Mill Levy

The maximum debt service mill levy that District Nos. 5, 6, and 8 are permitted to impose under their respective Service Plans ("**Debt Mill Levy Cap**") shall be determined as follows: (1) for the portion of any aggregate District's debt which exceeds fifty percent (50%) of the District's assessed valuation, the maximum debt mill levy for such portion of debt shall be fifty (50) mills less the number of mills necessary to pay unlimited mill levy debt. The Debt Mill Levy Cap may be adjusted due to changes in the statutory or constitutional method of assessing property tax or in the assessment ratio. The purpose of such adjustment is to assure, to the extent possible, that the actual tax revenues generated by the mill levy are neither decreased nor increased, as shown in the example below.

Regional Mill Levy

Pursuant to its Service Plan, District No. 4 will impose a Regional Mill Levy in the amount of one (1) mill ("**Regional Mill Levy**") for payment of the costs of planning, design, permitting, construction, acquisition and financing of the Regional Improvements (as defined in the Service Plan). Pursuant to the Pledge Agreement, the Taxing Districts will not be required to impose a Regional Improvements Mill Levy (as defined in the Service Plans) to provide regional improvements for so long as District No. 4 certifies the Contractual Debt Levy (as defined in the Mill Levy Pledge Agreement and below) and remits the same to the City in accordance with the terms of the Pledge Agreement.

Operations Mill Levy

In addition to imposing a debt service mill levy, the Districts are also authorized by their respective Service Plans to impose a separate mill levy to generate revenues for the provision of administrative, operations and maintenance services (the “**Operations and Maintenance Mill Levy**”). The amount of the Operations and Maintenance Mill Levy may be increased as necessary, separate and apart from the Debt Mill Levy Cap.

THE FOLLOWING EXAMPLE IS PROVIDED SOLELY FOR THE PURPOSE OF ILLUSTRATION AND IS NOT TO BE INTERPRETED AS A REPRESENTATION OF ANY ACTUAL CURRENT OR FUTURE VALUE INCLUDING, BUT NOT LIMITED TO, ANY ACTUAL VALUE, ASSESSMENT RATIO, OR MILL LEVY.

District Property Tax Calculation Example-Reduction in Residential Assessment Ratio

Tax Collection Year	Actual Value (V)	Residential Assessment Ratio (R)	Assessed Value (AV) [V x R = AV]	Mill Levy ¹ /Rate ² (M)	Amount of District Tax Due [AV x M]
(a) 2005	\$500,000	7.96%	\$39,800	50.000/.05000	\$1,990
(b) 2021	\$500,000	7.15%	\$35,750	55.664/.055664	\$1,990
(c) 2024	\$500,000	³ 6.70% (single family)	\$29,815	66.745/.066745	\$1,990
		³ 6.70% (multi-family)	\$29,815	66.745/.066745	\$1,990

¹ Based on a projected mill levy, not a representation of any actual current or future mill levy

² Each mill is equal to 1/1000th of a dollar

³ The Colorado General Assembly passed Senate Bill 22-238 in 2022 which created multiple classes of property. For the sake of simplicity, this example only contains assessment ratios for single family and multi-family categories. In 2023, the Colorado General Assembly passed 23B-001, which set the Assessment Ratio for single family and multi-family property at 6.70% after the deduction from the Actual Value of the property of the lesser of either (1) \$55,000 or (2) the amount that causes the Assessed Value to be \$1,000 for property tax assessment year 2023.

(a) If in 2005 the Actual Value of the property was \$500,000, and the Residential Assessment Ratio established by the State Legislature for that year was 7.96%, the Assessed Value of the property was \$39,800 (i.e., \$500,000 x 7.96% = \$39,800). If the District certified a combined debt and operations mill levy of 50 mills, it would have generated approximately \$1,990 in revenue for the District.

(b) If in 2021 the Actual Value of the property remained at \$500,000 and the Residential Assessment Ratio decreased to 7.15%, the Assessed Value would be \$35,750 (i.e., \$500,000 x 7.15% = \$35,750). Therefore, the District would certify a 55.664 mill levy in order to generate the same revenue as in 2005.

(c) If in 2024 the Actual Value of the property remained \$500,000 and both the single family and the multi-family Residential Assessment Ratio was decreased to 6.70%, the Assessed Value for both a single family and a multi-family residential unit would be \$29,815 (i.e. $[\$500,000 - \$55,000] \times 6.95\% = \$29,815$). Because the single family Residential Assessment Ratio and the multi-family Residential Assessment Ratio were set at the same rate in 2023, if the District was comprised of solely residential units (single family or multi-family), it would need to certify a 66.745 mill levy in order to generate the same revenue as in 2005.

(d) *Fees*

The Districts have the power to assess fees, rates, tolls, penalties, or charges as provided in Title 32 of the Colorado Revised Statutes, as amended. District Nos. 5 and 6 and District Nos. 5 and 8 have adopted joint resolutions (as amended, “**Development Fee Resolutions**”) imposing one-time development fees (“**Development Fee**”) to assist in defraying the costs associated with the financing and construction of Public Improvements (as defined in the Service Plans) to be provided within the boundaries and/or service area of the Taxing Districts. The Development Fees are set forth below and shall be due and payable to District No. 5 ten (10) days after issuance of a building permit by the City.

Single-Family Residential Dwelling Unit	\$2,000.00
Multi-Family Residential Dwelling Unit	\$1,000.00
Commercial Space	\$1.00 / sq. ft.

District Nos. 5 and 6 and District Nos. 5 and 8 have also adopted joint resolutions (as amended, “**Water Resource Credit Fee Resolutions**”) imposing one-time fees (“**Water Resource Credit Fees**”) to defray and repaying the costs associated with the in the cost associated with development, including particularly, the connection to water utility systems. The Water Resource Credit Fees are collected in lieu of and in an amount equal to the Water Resource Toll fixed by the Parker Water and Sanitation District.

Copies of the Development Fee Resolutions and Water Resource Credit Fee Resolutions may be obtained from the District Manager at the contact information below and are posted on the Districts’ website.

In addition to property taxes, the District may also rely upon various other revenue sources authorized by law to offset the expenses of capital construction and district management, operations and maintenance. For a current fee schedules, please contact the District Manager at the contact information below.

DISTRICTS’ BOUNDARIES

This Disclosure shall apply to the property within the boundaries of the Districts, which property is described on **Exhibit A** and **Exhibit B**, both attached hereto and incorporated herein by this reference.

CONTACT INFORMATION

Should you have any questions with regard to these matters, please contact:

District Manager:
CliftonLarsonAllen LLP
8390 E Crescent Parkway, Suite 300
Greenwood Village, CO 80111

Phone: (303) 779-5710

Dated May 1, 2024.

EXHIBIT A

Map of the East Side Property

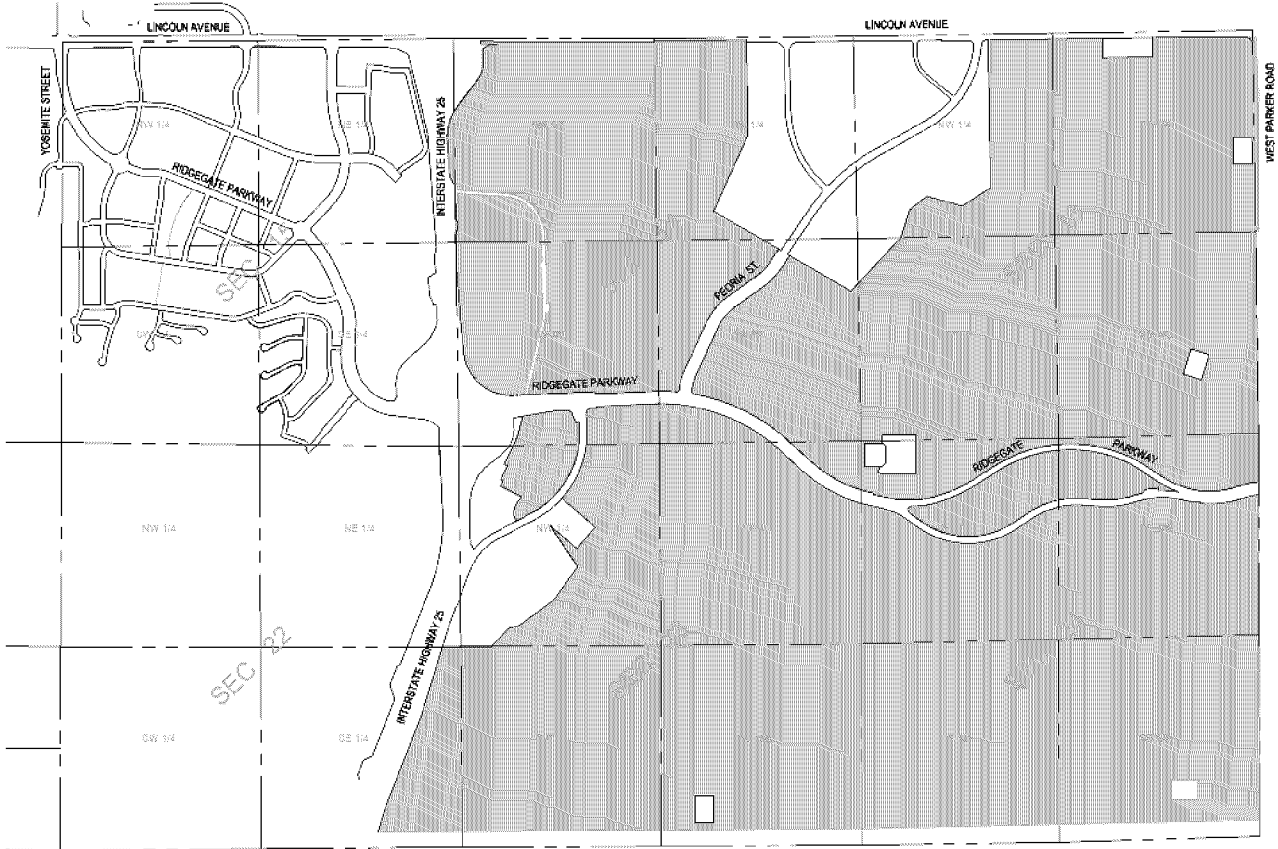

EXHIBIT B-4

Legal Description of Rampart Range Metropolitan District No. 4 Boundaries

Rampart Range Metropolitan District No. 4

PROPERTY DESCRIPTION:

A PARCEL OF LAND LOCATED IN SECTION 13, 14, 15, 22, 23 AND 24 TOWNSHIP 6 SOUTH, RANGE 67 WEST OF THE SIXTH PRINCIPAL MERIDIAN, CITY OF LONE TREE, COUNTY OF DOUGLAS, STATE OF COLORADO, BEING MORE PARTICULARLY DESCRIBED AS FOLLOWS:

BEARINGS ARE ASSUMED AND ARE BASED UPON THE EASTERLY LINE OF THE NORTHEAST QUARTER OF SAID SECTION 24, AS BEARING $S00^{\circ}12'56''E$ BETWEEN THE NORTHEAST CORNER OF SAID SECTION 24, BEING A 1 1/2" COPPERWELD SET IN A 6" DIAMETER CONCRETE POST AND THE EAST QUARTER CORNER OF SAID SECTION 24 BEING A 1 1/2" COPPERWELD SET IN A 6" DIAMETER CONCRETE POST

BEGINNING AT SAID NORTHEAST CORNER OF SECTION 24;

THENCE $S00^{\circ}12'56''E$ ALONG SAID EASTERLY LINE OF THE NORTHEAST QUARTER OF SECTION 24 A DISTANCE OF 2646.53 FEET TO SAID EAST QUARTER CORNER OF SECTION 24;

THENCE $S00^{\circ}11'42''E$ ALONG THE EASTERLY LINE OF THE SOUTHEAST QUARTER OF SAID SECTION 24 A DISTANCE OF 2436.88 FEET;

THENCE $S88^{\circ}19'00''W$ ALONG A LINE BEING 210.00 FEET NORTHERLY OF AND PARALLEL WITH THE SOUTHERLY LINE OF SAID SOUTHEAST QUARTER OF SECTION 24, A DISTANCE OF 2636.60 FEET TO THE WESTERLY LINE OF SAID SOUTHEAST QUARTER OF SECTION 24;

THENCE $S89^{\circ}16'29''W$ CONTINUING ALONG A LINE BEING 210.00 FEET NORTHERLY OF AND PARALLEL WITH THE SOUTHERLY LINE OF THE SOUTHWEST QUARTER OF SAID SECTION 24, A DISTANCE OF 2596.63 FEET TO THE WESTERLY LINE OF SAID SOUTHWEST QUARTER OF SECTION 24;

THENCE $S89^{\circ}32'02''W$ CONTINUING ALONG A LINE BEING 210.00 FEET NORTHERLY OF AND PARALLEL WITH THE SOUTHERLY LINE OF THE SOUTHEAST QUARTER OF SAID SECTION 23, A DISTANCE OF 2635.23 FEET TO THE WESTERLY LINE OF SAID SOUTHEAST QUARTER OF SECTION 23;

THENCE $S89^{\circ}48'08''W$ CONTINUING ALONG A LINE BEING 210.00 FEET NORTHERLY OF AND PARALLEL WITH THE SOUTHERLY LINE OF THE SOUTHWEST QUARTER OF SAID SECTION 23, A DISTANCE OF 2616.46 FEET TO THE WESTERLY LINE OF SAID SOUTHWEST QUARTER OF SECTION 23;

THENCE $S89^{\circ}27'49''W$ CONTINUING ALONG A LINE BEING 210.00 FEET NORTHERLY OF AND PARALLEL WITH THE SOUTHERLY LINE OF THE SOUTHEAST QUARTER OF SAID SECTION 22, A DISTANCE OF 1307.29 FEET TO THE EASTERLY RIGHT-OF-WAY OF INTERSTATE HIGHWAY 25 AS DESCRIBED IN BOOK 104 AT PAGE 136 AND IN BOOK 861 AT PAGE 154 RECORDED IN THE OFFICE OF THE DOUGLAS COUNTY CLERK AND RECORDER;

THENCE ALONG SAID EASTERLY RIGHT-OF-WAY THE FOLLOWING ELEVEN (11) COURSES:

1. $N21^{\circ}26'00''E$ A DISTANCE OF 728.59 FEET;
2. THENCE $N66^{\circ}26'21''E$ A DISTANCE OF 141.30 FEET;

3. THENCE N21°26'10"E A DISTANCE OF 149.88 FEET;
4. THENCE N23°33'50"W A DISTANCE OF 140.35 FEET;
5. THENCE N21°26'41"E A DISTANCE OF 698.49 FEET;
6. THENCE N21°28'45"E A DISTANCE OF 616.32 FEET;
7. THENCE N21°28'37"E A DISTANCE OF 238.78 FEET;
8. THENCE N27°27'15"E A DISTANCE OF 640.16 FEET;
9. THENCE N16°11'56"E A DISTANCE OF 720.57 FEET;
10. THENCE N30°37'37"W A DISTANCE OF 92.85 FEET;
11. THENCE N01°59'52"W A DISTANCE OF 403.37 FEET TO THE SOUTHERLY CORNER OF PARCEL 1 AS DESCRIBED AT RECEPTION NO. 2007037627 RECORDED IN THE OFFICE OF THE DOUGLAS COUNTY CLERK AND RECORDER;

THENCE CONTINUING ALONG SAID EASTERLY RIGHT-OF-WAY THE FOLLOWING ELEVEN (11) COURSES:

1. THENCE N03°27'09"E TANGENT WITH THE FOLLOWING DESCRIBED CURVE A DISTANCE OF 164.03 FEET;
2. THENCE ALONG THE ARC OF A CURVE TO THE RIGHT, HAVING A CENTRAL ANGLE OF 41°16'00", A RADIUS OF 659.00 FEET, A CHORD BEARING N24°05'08"E A DISTANCE OF 464.44 FEET, AND AN ARC DISTANCE OF 474.64 FEET;
3. THENCE N50°57'56"E TANGENT WITH THE LAST AND FOLLOWING DESCRIBED CURVES A DISTANCE OF 300.42 FEET;
4. THENCE ALONG THE ARC OF A CURVE TO THE LEFT, HAVING A CENTRAL ANGLE OF 53°33'48", A RADIUS OF 420.00 FEET, A CHORD BEARING N24°11'02"E A DISTANCE OF 378.50 FEET, AND AN ARC DISTANCE OF 392.64 FEET;
5. THENCE N02°35'52"W TANGENT WITH THE LAST AND FOLLOWING DESCRIBED CURVES A DISTANCE OF 130.67 FEET;
6. THENCE ALONG THE ARC OF A CURVE TO THE RIGHT, HAVING A CENTRAL ANGLE OF 83°51'02", A RADIUS OF 75.00 FEET, A CHORD BEARING N39°19'39"E A DISTANCE OF 100.22 FEET, AND AN ARC DISTANCE OF 109.76 FEET;
7. THENCE N02°35'52"W NON-TANGENT WITH THE LAST DESCRIBED CURVE A DISTANCE OF 217.72 FEET;
8. THENCE S87°52'30"W TANGENT WITH THE FOLLOWING DESCRIBED CURVE A DISTANCE OF 63.86 FEET;

9. THENCE ALONG THE ARC OF A CURVE TO THE RIGHT, HAVING A CENTRAL ANGLE OF 85°25'44", A RADIUS OF 620.00 FEET, A CHORD BEARING N49°24'37"W A DISTANCE OF 841.15 FEET, AND AN ARC DISTANCE OF 924.43 FEET;

10. THENCE N06°41'45"W TANGENT WITH THE LAST AND FOLLOWING DESCRIBED CURVES A DISTANCE OF 287.51 FEET;

11. THENCE ALONG THE ARC OF A CURVE TO THE RIGHT, HAVING A CENTRAL ANGLE OF 01°32'21", A RADIUS OF 4945.00 FEET, A CHORD BEARING N05°55'35"W A DISTANCE OF 132.84 FEET, AND AN ARC DISTANCE OF 132.85 FEET TO NORTHERLY CORNER OF SAID PARCEL 1;

THENCE CONTINUING ALONG SAID EASTERLY RIGHT-OF-WAY AS DESCRIBED IN SAID BOOK 104 AT PAGE 136 AND IN BOOK 861 AT PAGE 154 THE FOLLOWING SIX (6) COURSES:

1. THENCE ALONG THE ARC OF A NON-TANGENT CURVE TO THE LEFT, HAVING A CENTRAL ANGLE OF 01°05'13", A RADIUS OF 11560.00 FEET, A CHORD BEARING N03°41'55"W A DISTANCE OF 219.30 FEET, AND AN ARC DISTANCE OF 219.31 FEET;

2. THENCE N04°09'56"W NON-TANGENT WITH THE LAST DESCRIBED CURVE A DISTANCE OF 609.31 FEET;

3. THENCE N00°47'00"W A DISTANCE OF 319.59 FEET;

4. THENCE N22°18'30"E A DISTANCE OF 68.40 FEET;

5. THENCE N04°15'32"W A DISTANCE OF 442.49 FEET;

6. THENCE N00°47'00"W A DISTANCE OF 140.70 FEET TO SAID EASTERLY RIGHT-OF-WAY OF INTERSTATE HIGHWAY I-25 AS DESCRIBED AT RECEPTION NO. 2012069038 RECORDED IN THE OFFICE OF THE DOUGLAS COUNTY CLERK AND RECORDER;

THENCE CONTINUING ALONG SAID EASTERLY RIGHT-OF-WAY THE FOLLOWING FIVE (5) COURSES:

1. THENCE N17°50'41"W A DISTANCE OF 119.42 FEET;

2. THENCE N04°12'36"W NON-TANGENT WITH THE FOLLOWING DESCRIBED CURVE A DISTANCE OF 553.17 FEET;

3. THENCE ALONG THE ARC OF A CURVE TO THE RIGHT, HAVING A CENTRAL ANGLE OF 26°44'42", A RADIUS OF 705.96 FEET, A CHORD BEARING N17°35'46"E A DISTANCE OF 326.55 FEET, AND AN ARC DISTANCE OF 329.53 FEET;

4. THENCE N52°39'54"W NON-TANGENT WITH THE LAST DESCRIBED CURVE A DISTANCE OF 7.36 FEET;

5. THENCE N37°19'34"E A DISTANCE OF 56.45 FEET TO SAID EASTERLY RIGHT-OF-WAY OF INTERSTATE HIGHWAY I-25 AS DESCRIBED AT RECEPTION NO. 2010058328 RECORDED IN THE OFFICE OF THE DOUGLAS COUNTY CLERK AND RECORDER;

THENCE CONTINUING ALONG SAID EASTERLY RIGHT-OF-WAY THE FOLLOWING FIVE (5) COURSES:

1. THENCE S54°28'53"E NON-TANGENT WITH THE FOLLOWING DESCRIBED CURVE A DISTANCE OF 25.24 FEET;
2. THENCE ALONG THE ARC OF A CURVE TO THE RIGHT, HAVING A CENTRAL ANGLE OF 01°49'04", A RADIUS OF 683.94 FEET, A CHORD BEARING N36°25'34"E A DISTANCE OF 21.70 FEET, AND AN ARC DISTANCE OF 21.70 FEET;
3. THENCE N37°20'06"E TANGENT WITH THE FOLLOWING DESCRIBED CURVE A DISTANCE OF 416.89 FEET;
4. THENCE ALONG THE ARC OF A CURVE TO THE LEFT, HAVING A CENTRAL ANGLE OF 37°25'35", A RADIUS OF 390.50 FEET, A CHORD BEARING N18°37'18"E A DISTANCE OF 250.57 FEET, AND AN ARC DISTANCE OF 255.08 FEET;
5. THENCE N00°05'30"W TANGENT WITH THE LAST DESCRIBED CURVE A DISTANCE OF 168.59 FEET TO THE SOUTHERLY RIGHT-OF-WAY OF LINCOLN AVENUE AS DESCRIBED AT RECEPTION NO. 2008035981 RECORDED IN THE OFFICE OF THE DOUGLAS COUNTY CLERK AND RECORDER;

THENCE ALONG SAID SOUTHERLY RIGHT-OF-WAY THE FOLLOWING THREE (3) COURSES:

1. N89°34'46"E A DISTANCE OF 2075.86 FEET;
2. THENCE N54°37'19"E A DISTANCE OF 61.09 FEET;
3. THENCE N89°34'46"E A DISTANCE OF 1293.85 FEET TO THE WESTERLY LINE OF MERIDIAN INTERNATIONAL BUSINESS CENTER 5 AMENDMENT 8 RECORDED AT RECEPTION NO. 2003007920 IN THE OFFICE OF THE DOUGLAS COUNTY CLERK AND RECORDER;

THENCE S00°41'16"E ALONG SAID WESTERLY LINE A DISTANCE OF 1165.23 FEET TO THE SOUTHWESTERLY CORNER OF MERIDIAN INTERNATIONAL BUSINESS CENTER 5 AMENDMENT 15 RECORDED AT RECEPTION NO. 2007010231 IN THE OFFICE OF THE DOUGLAS COUNTY CLERK AND RECORDER;

THENCE S24°15'30"W ALONG THE NORTHWESTERLY LINE OF MERIDIAN INTERNATIONAL BUSINESS CENTER 5 AMENDMENT 3 RECORDED AT RECEPTION NO. 2001054981 IN THE OFFICE OF THE DOUGLAS COUNTY CLERK AND RECORDER A DISTANCE OF 1094.15 FEET TO THE WESTERLY CORNER OF SAID MERIDIAN INTERNATIONAL BUSINESS CENTER 5 AMENDMENT 3;

THENCE S59°46'40"E ALONG THE SOUTHWESTERLY LINE OF SAID MERIDIAN INTERNATIONAL BUSINESS CENTER 5 AMENDMENT 3 A DISTANCE OF 2090.20 FEET TO THE SOUTHERLY CORNER OF MERIDIAN INTERNATIONAL BUSINESS CENTER 5 AMENDMENT 1;

THENCE ALONG THE SOUTHEASTERLY AND EASTERLY LINES OF SAID MERIDIAN INTERNATIONAL BUSINESS CENTER 5 AMENDMENT 1 THE FOLLOWING SIX (6) COURSES;

1. N42°58'25"E A DISTANCE OF 969.14 FEET;
2. THENCE N16°51'42"E A DISTANCE OF 371.65 FEET;
3. THENCE N51°35'55"E A DISTANCE OF 292.06 FEET;
4. THENCE S74°53'36"E A DISTANCE OF 487.64 FEET;
5. THENCE N56°46'26"E A DISTANCE OF 436.36 FEET;
6. THENCE N01°01'20"W A DISTANCE OF 1926.90 FEET TO THE SOUTHERLY RIGHT-OF-WAY OF LINCOLN AVENUE AS DESCRIBED AT RECEPTION NO. 2008035982 RECORDED IN THE OFFICE OF THE DOUGLAS COUNTY CLERK AND RECORDER;

THENCE ALONG SAID SOUTHERLY RIGHT-OF-WAY THE FOLLOWING FOUR (4) COURSES:

1. N89°05'44"E A DISTANCE OF 845.83 FEET;
2. THENCE N89°10'43"E A DISTANCE OF 446.42 FEET;
3. THENCE N00°49'17"W A DISTANCE OF 15.00 FEET;
4. THENCE N89°10'42"E A DISTANCE OF 213.07 FEET TO THE WESTERLY LINE OF THAT PARCEL OF LAND DESCRIBED AT RECEPTION NO. 2005051824 RECORDED IN THE OFFICE OF THE DOUGLAS COUNTY CLERK AND RECORDER;

THENCE ALONG THE WESTERLY, SOUTHERLY AND EASTERLY LINES OF SAID PARCEL THE FOLLOWING THREE (3) COURSES:

1. S00°48'51"E A DISTANCE OF 251.79 FEET;
2. THENCE N89°09'53"E A DISTANCE OF 658.98 FEET;
3. THENCE N00°42'56"W A DISTANCE OF 251.64 FEET TO THE SOUTHERLY RIGHT-OF-WAY OF LINCOLN AVENUE AS DESCRIBED AT RECEPTION NO. 9403619, RECORDED IN THE OFFICE OF THE DOUGLAS COUNTY CLERK AND RECORDER;

THENCE ALONG SAID SOUTHERLY RIGHT-OF-WAY THE FOLLOWING TWO (2) COURSES:

1. N89°10'42"E A DISTANCE OF 353.30 FEET;
2. THENCE S00°40'52"E A DISTANCE OF 14.91 FEET TO THE NORTHWESTERLY CORNER OF LINCOLN AVENUE RIGHT-OF-WAY AS DESCRIBED AT RECEPTION NO. 2004100332, RECORDED IN THE OFFICE OF THE DOUGLAS COUNTY CLERK AND RECORDER;

THENCE CONTINUING ALONG SAID SOUTHERLY RIGHT-OF-WAY OF LINCOLN AVENUE THE FOLLOWING THREE (3) COURSES:

1. S00°40'52"E A DISTANCE OF 5.88 FEET;

2. THENCE N89°06'58"E TANGENT WITH THE FOLLOWING DESCRIBED CURVE A DISTANCE OF 893.78 FEET;

3. THENCE ALONG THE ARC OF A CURVE TO THE RIGHT, HAVING A CENTRAL ANGLE OF 90°23'19", A RADIUS OF 50.00 FEET, A CHORD BEARING S45°41'13"E A DISTANCE OF 70.95 FEET, AND AN ARC DISTANCE OF 78.88 FEET TO THE WESTERLY RIGHT-OF-WAY OF WEST PARKER ROAD AS DESCRIBED IN BOOK 861 AT PAGE 154, RECORDED IN THE OFFICE OF THE DOUGLAS COUNTY CLERK AND RECORDER;

THENCE S00°31'30"E ALONG SAID WESTERLY RIGHT-OF-WAY OF WEST PARKER ROAD A DISTANCE OF 2500.31 FEET TO THE SOUTHERLY LINE OF THE NORTHEAST QUARTER OF SAID SECTION 13;

THENCE N89°01'44"E ALONG SAID SOUTHERLY LINE A DISTANCE OF 34.00 FEET TO THE POINT OF BEGINNING.

CONTAINING 2,301.025 ACRES MORE OR LESS.

EXCEPT THE FOLLOWING DESCRIBED PARCELS OF LAND LYING WITHIN SECTIONS 13, 14, 22, 23, AND 24:

EXCEPT THAT PARCEL OF LAND GRANTED TO PUBLIC SERVICE COMPANY OF COLORADO RECORDED FEBRUARY 8, 2000 IN BOOK 1807 AT PAGE 2034, CONTAINING 1.915 ACRES MORE OR LESS.

EXCEPT THOSE PARCELS OF LAND CONVEYED TO THE CITY OF LONE TREE BY IN A CORRECTIVE DEED RECORDED MAY 8, 2007 AT RECEPTION NUMBER 2007037631, PARCEL A CONTAINING 6.024 ACRES AND PARCEL B CONTAINING 10.371 ACRES MORE OF LESS.

EXCEPT THAT PARCEL OF LAND CONVEYED TO THE CITY OF LONE TREE BY DEED REDORDED AUGUST 31, 2006 AT RECEPTION NUMBER 2006075141, CONTAINING 5.163 ACRES MORE OF LESS.

EXCEPT THAT PARCEL OF LAND CONVEYED TO SCHWEIGER RANCH FOUNDATION BY DEED REDORDED MAY 14, 2008 AT RECEPTION NUMBER 2008034431, CONTAINING 38.740 ACRES MORE OF LESS.

EXCEPT THAT PARCEL OF LAND CONVEYED TO RAMPART RANGE METROPOLITAN DISTRICT NO. 1, LOT 1-A, RIDGEGATE EAST-FILING NO. 1 1ST AMENDMENT, CONTAINING 11.957 ACRES MORE OF LESS.

EXCEPT THAT PARCEL OF LAND CONVEYED TO REGIONAL TRANSPORTATION DISTRICT BY BARGAIN AND SALE DEED, PARCEL SE 8D, RECORDED JUNE 3, 2016 AT RECEPTION NO. 2016035371, CONTAINING 0.681 ACRES MORE OF LESS.

EXCEPT THAT PARCEL OF LAND CONVEYED TO REGIONAL TRANSPORTATION DISTRICT BY BARGAIN AND SALE DEED, PARCEL SE 8EA, RECORDED JUNE 3, 2016 AT RECEPTION NO. 2016035371, CONTAINING 0.368 ACRES MORE OF LESS.

EXCEPT THAT PARCEL OF LAND CONVEYED TO REGIONAL TRANSPORTATION DISTRICT BY BARGAIN AND SALE DEED, PARCEL SE 8E REV2, RECORDED JUNE 3, 2016 AT RECEPTION NO. 2016035371, CONTAINING 2.365 ACRES MORE OF LESS.

EXCEPT THAT PARCEL OF LAND CONVEYED TO REGIONAL TRANSPORTATION DISTRICT BY BARGAIN AND SALE DEED, PARCEL SE 8J, RECORDED JUNE 3, 2016 AT RECEPTION NO. 2016035371, CONTAINING 0.218 ACRES MORE OF LESS.

EXCEPT THAT PARCEL OF LAND CONVEYED TO RAMPART RANGE METROPOLITAN DISTRICT NO. 1, PARCEL 7A, RECEPTION NO. 2014064316, RECORDED NOVEMBER 4, 2014, CONTAINING 5.0 ACRES MORE OF LESS.

EXCEPT THAT PARCEL OF LAND CONVEYED TO RAMPART RANGE METROPOLITAN DISTRICT NO. 1, PARCEL 5A, RECEPTION NO. 2014064314, RECORDED NOVEMBER 4, 2014, CONTAINING 2.0 ACRES MORE OF LESS.

EXCEPT THAT PARCEL OF LAND CONVEYED TO PARKER WATER AND SANITATION DISTRICT, WELL RRC-1, RECEPTION NO. 2007009356, RECORDED JANUARY 31, 2007, CONTAINING 2.0 ACRES MORE OF LESS.

EXCEPT THAT PARCEL OF LAND CONVEYED TO PARKER WATER AND SANITATION DISTRICT, WELL RRC-6, RECEPTION NO. 2007009356, RECORDED JANUARY 31, 2007, CONTAINING 5.0 ACRES MORE OF LESS.

EXCEPT THAT PARCEL OF LAND CONVEYED TO PARKER WATER AND SANITATION DISTRICT, WELL RRC-11, RECEPTION NO. 2007009356, RECORDED JANUARY 31, 2007, CONTAINING 2.0 ACRES MORE OF LESS.

EXCEPT THAT PARCEL OF LAND CONVEYED TO PARKER WATER AND SANITATION DISTRICT, WELL RRC-12, RECEPTION NO. 2007009356, RECORDED JANUARY 31, 2007, CONTAINING 2.0 ACRES MORE OF LESS.

EXHIBIT B-5

Legal Description of Rampart Range Metropolitan District No. 5 Boundaries

EXHIBIT A

NE QUARTER OF SECTION 13, TOWNSHIP 6 SOUTH, RANGE 67 WEST 6th P.M.
 -----COUNTY OF DOUGLAS-----

PROPERTY DESCRIPTION

A PARCEL OF LAND BEING A PORTION OF THE NORTHEAST QUARTER OF SECTION 13, TOWNSHIP 6 SOUTH, RANGE 67 WEST, OF THE 6TH PRINCIPAL MERIDIAN, COUNTY OF DOUGLAS, STATE OF COLORADO, BEING MORE PARTICULARLY DESCRIBED AS FOLLOWS:

BEARINGS ARE ASSUMED AND ARE BASED UPON THE NORTH LINE OF THE NORTHEAST QUARTER OF SAID SECTION 13, AS BEARING N89°10'42"E BETWEEN THE NORTH QUARTER CORNER OF SAID SECTION 13, BEING A FOUND 3" ALUMINUM CAP DOWN 0.5' IN RANGE BOX, STAMPING ILLEGIBLE AND THE NORTHEAST CORNER OF SAID SECTION 13, BEING A FOUND FOUND 3-1/4" ALUMINUM CAP DOWN 0.7' IN RANGE BOX, STAMPING ILLEGIBLE.

COMMENCING AT SAID NORTH QUARTER CORNER OF SECTION 13:

THENCE S72°38'20"E A DISTANCE OF 1061.45 FEET TO A POINT ON THE SOUTH LINE OF LINCOLN SELF STORAGE, A PLAT RECORDED AT RECEPTION NO. 2005051824 IN THE OFFICE OF THE DOUGLAS COUNTY CLERK AND RECORDER, SAID POINT BEING THE **POINT OF BEGINNING**;

THENCE N89°09'53"E ALONG SAID SOUTH LINE A DISTANCE OF 309.98 FEET;

THENCE S00°42'47"E NON-TANGENT WITH THE FOLLOWING DESCRIBED CURVE A DISTANCE OF 439.35 FEET;

THENCE ALONG THE ARC OF A CURVE TO THE RIGHT, HAVING A CENTRAL ANGLE OF 13°04'27", A RADIUS OF 303.13 FEET, A CHORD BEARING N82°08'07"W A DISTANCE OF 69.02 FEET, AND AN ARC DISTANCE OF 69.17 FEET;

THENCE ALONG THE ARC OF A NON-TANGENT CURVE TO THE LEFT, HAVING A CENTRAL ANGLE OF 18°00'56", A RADIUS OF 794.91 FEET, A CHORD BEARING N82°58'54"W A DISTANCE OF 248.92 FEET, AND AN ARC DISTANCE OF 249.94 FEET;

THENCE N00°00'00"E A DISTANCE OF 394.94 FEET TO THE **POINT OF BEGINNING**.

CONTAINING 128,716 SQUARE FEET (2.955 ACRES), MORE OR LESS.

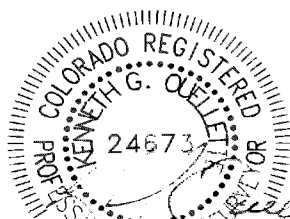

KENNETH G. OUELLETTE, P.L.S. 24673
 DATE: JULY 18, 2018
 JOB NO. 65119774
 FOR AND ON BEHALF OF MERRICK & COMPANY

REVISION DESCRIPTION	RAMPART RANGE METRO DISTRICT NO. 5	
MERRICK PROJECT NO. 65119774	DIRECTORS PARCEL	
DRAWN KGO	DATE: JULY 18, 2018	
MERRICK & COMPANY 5970 Greenwood Plaza Blvd., Greenwood Village, CO 80111 Telephone: 303-751-0741	SCALE: N/A	SHEET 1 OF 1

EXHIBIT B-6

Legal Description of Rampart Range Metropolitan District No. 6 Boundaries

District 6

SE 1/4, SECTION 24, TOWNSHIP 6 SOUTH,
 RANGE 67 WEST, 6th P.M.
 ----- COUNTY OF DOUGLAS, CITY OF LONE TREE -----

PARCEL DESCRIPTION

A PARCEL OF LAND BEING A PART OF THE SOUTHWEST QUARTER SECTION 13, TOWNSHIP 6 SOUTH, RANGE 67 WEST OF THE SIXTH PRINCIPAL MERIDIAN, CITY OF LONE TREE, COUNTY OF DOUGLAS, STATE OF COLORADO, MORE PARTICULARLY DESCRIBED AS FOLLOWS:

BEARINGS FOR THIS PARCEL DESCRIPTION ARE BASED ON THE SOUTH LINE OF SECTION 13, TOWNSHIP 6 SOUTH, RANGE 67 WEST OF THE SIXTH PRINCIPAL MERIDIAN BEING ASSUMED TO BEAR NORTH 89°17'15" EAST;

COMMENCING AT THE SOUTHWEST CORNER OF SAID SECTION 13;

THENCE NORTH 00°47'08" WEST, ALONG THE WEST LINE OF SAID SOUTHWEST QUARTER, A DISTANCE OF 1887.82 FEET TO THE POINT OF BEGINNING;

THENCE CONTINUING NORTH 00°47'08" WEST, ALONG SAID WEST LINE, A DISTANCE OF 104.50 FEET;

THENCE NORTH 88°12'54" EAST, A DISTANCE OF 104.50 FEET;

THENCE SOUTH 00°47'08" EAST, ALONG A LINE BEING 104.50 FEET EASTERLY DISTANT AND PARALLEL, WHEN MEASURED AT RIGHT ANGLES, WITH SAID WEST LINE, A DISTANCE OF 104.50 FEET;

THENCE SOUTH 88°12'54" WEST, A DISTANCE OF 104.50 FEET TO THE POINT OF BEGINNING;

SAID PARCEL CONTAINING 10,820 SQUARE FEET (0.25 ACRES), MORE OR LESS.

I, WILLIAM F. HESSELBACH, JR., A SURVEYOR LICENSED IN THE STATE OF COLORADO, DO HEREBY CERTIFY THAT THE ABOVE PARCEL DESCRIPTION AND ATTACHED EXHIBIT WERE PREPARED BY ME OR UNDER MY DIRECT SUPERVISION AND CHECKING.

William F. Hesselbach, Jr.
 WILLIAM F. HESSELBACH, JR., P.L.S. NO. 20889
 FOR AND ON BEHALF OF CARROLL & LANGE, INC.



LEGEND EASEMENT ACQUIRED	DOCUMENT DATED SECY FILE DOC. RANGE FROM NO. CADD NO. DIST. BY INSTR. _____ IS. AD. _____ SHEET 1 OF 2 SHEETS	RAMPART RANGE METRO DISTRICT NO. 6 EXHIBIT FOR DIRECTOR PARCEL DISTRICT 6
	DATE: FEBRUARY 24, 2009 SCALE: 1" = 100'	JUR-6-2

FILE NO. P:\2009\0209\2009-0209\0209\0209-1-2.DWG

AND

Legal Description

RIDGEGATE SW VILLAGE FILING NO. 1

LEGAL DESCRIPTION

A PARCEL OF LAND BEING A PART OF THE NORTH HALF AND SOUTHEAST QUARTER OF SECTION 23, A PART OF THE NORTHWEST QUARTER OF SECTION 24, AND A PART OF THE SOUTH HALF OF SECTION 14, ALL IN TOWNSHIP 6 SOUTH, RANGE 67 WEST OF THE SIXTH PRINCIPAL MERIDIAN, COUNTY OF DOUGLAS, STATE OF COLORADO, BEING MORE PARTICULARLY DESCRIBED AS FOLLOWS:

BASIS OF BEARINGS: THE SOUTH LINE OF THE NORTHEAST QUARTER OF SAID SECTION 23, BEARS NORTH 89°35'02" EAST, A DISTANCE OF 2,635.44 FEET, WITH ALL BEARINGS CONTAINED HEREIN RELATIVE THERETO.

COMMENCING AT THE CENTER QUARTER CORNER OF SAID SECTION 23;

THENCE NORTH 15°34'02" EAST, A DISTANCE OF 144.38 FEET TO THE **POINT OF BEGINNING**;

THENCE NORTH 09°37'05" EAST, A DISTANCE OF 318.79 FEET TO THE BEGINNING OF A TANGENT CURVE CONCAVE EASTERLY HAVING A RADIUS OF 745.50 FEET;

THENCE NORTHERLY ALONG SAID CURVE THROUGH A CENTRAL ANGLE OF 01°42'04", AN ARC LENGTH OF 22.13 FEET TO THE BEGINNING OF A REVERSE CURVE CONCAVE SOUTHWESTERLY HAVING A RADIUS OF 22.00 FEET;

THENCE NORTHWESTERLY ALONG SAID CURVE THROUGH A CENTRAL ANGLE OF 84°27'18", AN ARC LENGTH OF 32.43 FEET;

THENCE NORTH 73°08'09" WEST, A DISTANCE OF 584.01 FEET;

THENCE SOUTH 16°51'51" WEST, A DISTANCE OF 207.75 FEET;

THENCE NORTH 68°03'49" WEST, A DISTANCE OF 146.41 FEET TO THE BEGINNING OF A NON-TANGENT CURVE CONCAVE SOUTHERLY HAVING A RADIUS OF 636.86 FEET, THE RADIUS POINT OF SAID CURVE BEARS SOUTH 20°06'31" WEST;

THENCE WESTERLY ALONG SAID CURVE THROUGH A CENTRAL ANGLE OF 33°33'35", AN ARC LENGTH OF 373.03 FEET;

THENCE SOUTH 76°32'57" WEST, A DISTANCE OF 440.26 FEET;

THENCE NORTH 13°27'03" WEST, A DISTANCE OF 93.54 FEET TO THE SOUTHERLY BOUNDARY OF THAT BARGAIN AND SALE DEED RECORDED AT RECEPTION NO. 2008034431, OF THE RECORDS OF THE DOUGLAS COUNTY CLERK AND RECORDER'S OFFICE;

THENCE ALONG SAID SOUTHERLY BOUNDARY, NORTH 53°27'29" EAST, A DISTANCE OF 107.42 FEET;

THENCE DEPARTING SAID SOUTHERLY BOUNDARY, NORTH 23°54'07" EAST, A DISTANCE OF 588.85 FEET TO THE NORTHEASTERLY BOUNDARY OF SAID BARGAIN AND SALE DEED;

THENCE ALONG SAID NORTHEASTERLY BOUNDARY, NORTH 33°41'49" WEST, A DISTANCE OF 523.60 FEET TO THE SOUTHWESTERLY BOUNDARY OF THAT SPECIAL WARRANTY DEED RECORDED AT RECEPTION NO. 2014064760, IN SAID RECORDS;
THENCE ALONG SAID SOUTHWESTERLY BOUNDARY AND THE SOUTHEASTERLY AND NORTHEASTERLY BOUNDARY THE FOLLOWING THREE (3) COURSES:

1. SOUTH 49°12'44" EAST, A DISTANCE OF 462.00 FEET
2. NORTH 40°47'16" EAST, A DISTANCE OF 371.30 FEET;
3. NORTH 49°12'44" WEST, A DISTANCE OF 161.83 FEET TO THE EASTERLY BOUNDARY OF RIDGEGATE EAST FILING NO. 2, A PLAT RECORDED UNDER RECEPTION NO. 2020097699, IN SAID RECORDS AND THE BEGINNING OF A NON-TANGENT CURVE CONCAVE NORTHWESTERLY HAVING A RADIUS OF 1,717.90 FEET, THE RADIUS POINT OF SAID CURVE BEARS NORTH 48°27'57" WEST;

THENCE ALONG SAID EASTERLY BOUNDARY THE FOLLOWING EIGHTEEN (18) COURSES:

1. NORTHEASTERLY ALONG SAID CURVE THROUGH A CENTRAL ANGLE OF 18°24'39", AN ARC LENGTH OF 552.01 FEET;
2. NORTH 26°27'05" EAST, A DISTANCE OF 110.50 FEET;
3. SOUTH 63°32'55" EAST, A DISTANCE OF 80.39 FEET;
4. NORTH 56°32'09" EAST, A DISTANCE OF 61.15 FEET;
5. SOUTH 60°42'14" EAST, A DISTANCE OF 59.61 FEET;
6. SOUTH 29°45'20" EAST, A DISTANCE OF 22.96 FEET;
7. SOUTH 78°42'29" EAST, A DISTANCE OF 75.34 FEET;
8. NORTH 46°13'36" EAST, A DISTANCE OF 132.79 FEET;
9. NORTH 42°31'28" EAST, A DISTANCE OF 146.82 FEET;
10. NORTH 02°20'12" WEST, A DISTANCE OF 89.87 FEET;
11. NORTH 47°11'52" WEST, A DISTANCE OF 79.84 FEET;
12. NORTH 09°18'42" EAST, A DISTANCE OF 231.91 FEET;
13. NORTH 80°17'49" EAST, A DISTANCE OF 143.19 FEET;
14. NORTH 68°39'37" EAST, A DISTANCE OF 120.54 FEET;
15. NORTH 42°38'06" EAST, A DISTANCE OF 232.92 FEET;
16. NORTH 67°36'20" EAST, A DISTANCE OF 42.82 FEET;
17. NORTH 87°46'47" EAST, A DISTANCE OF 134.01 FEET;
18. NORTH 09°03'38" EAST, A DISTANCE OF 149.62 FEET TO THE SOUTHERLY RIGHT-OF-WAY OF RIDGEGATE PARKWAY AND THE BEGINNING OF A NON-TANGENT CURVE

CONCAVE SOUTHWESTERLY HAVING A RADIUS OF 2,316.00 FEET, THE RADIUS POINT OF SAID CURVE BEARS SOUTH 09°53'39" WEST;

THENCE ALONG SAID SOUTHERLY RIGHT-OF-WAY THE FOLLOWING THREE (3) COURSES:

1. SOUTHEASTERLY ALONG SAID CURVE THROUGH A CENTRAL ANGLE OF 32°19'33", AN ARC LENGTH OF 1,306.67 FEET;
2. SOUTH 47°46'48" EAST, A DISTANCE OF 423.77 FEET TO THE BEGINNING OF A TANGENT CURVE CONCAVE NORTHEASTERLY HAVING A RADIUS OF 1,884.00 FEET;
3. SOUTHEASTERLY ALONG SAID CURVE THROUGH A CENTRAL ANGLE OF 02°42'04", AN ARC LENGTH OF 88.82 FEET;

THENCE DEPARTING SAID SOUTHERLY RIGHT-OF-WAY, SOUTH 39°40'25" WEST, A DISTANCE OF 30.83 FEET;

THENCE NORTH 50°19'35" WEST, A DISTANCE OF 29.19 FEET;

THENCE SOUTH 42°13'12" WEST, A DISTANCE OF 179.60 FEET;

THENCE SOUTH 47°30'39" WEST, A DISTANCE OF 213.09 FEET TO THE BEGINNING OF A NON-TANGENT CURVE CONCAVE NORTHWESTERLY HAVING A RADIUS OF 642.00 FEET, THE RADIUS POINT OF SAID CURVE BEARS NORTH 45°12'13" WEST;

THENCE SOUTHWESTERLY ALONG SAID CURVE THROUGH A CENTRAL ANGLE OF 09°14'54", AN ARC LENGTH OF 103.63 FEET TO THE BEGINNING OF A REVERSE CURVE HAVING A RADIUS OF 5.00 FEET;

THENCE SOUTHERLY ALONG SAID CURVE THROUGH A CENTRAL ANGLE OF 85°31'25", AN ARC LENGTH OF 7.46 FEET;

THENCE SOUTH 31°28'43" EAST, A DISTANCE OF 180.92 FEET TO THE BEGINNING OF A TANGENT CURVE CONCAVE NORTHEASTERLY HAVING A RADIUS OF 524.50 FEET;

THENCE SOUTHEASTERLY ALONG SAID CURVE THROUGH A CENTRAL ANGLE OF 11°36'10", AN ARC LENGTH OF 106.22 FEET;

THENCE SOUTH 46°07'04" EAST, A DISTANCE OF 11.32 FEET TO THE BEGINNING OF A TANGENT CURVE CONCAVE NORTHERLY HAVING A RADIUS OF 5.00 FEET;

THENCE EASTERLY ALONG SAID CURVE THROUGH A CENTRAL ANGLE OF 85°20'56", AN ARC LENGTH OF 7.45 FEET;

THENCE NORTH 48°32'00" EAST, A DISTANCE OF 12.74 FEET;

THENCE NORTH 41°06'26" EAST, A DISTANCE OF 12.00 FEET;

THENCE SOUTH 48°57'24" EAST, A DISTANCE OF 71.00 FEET;

THENCE SOUTH 41°02'36" WEST, A DISTANCE OF 12.00 FEET;

THENCE SOUTH 33°29'25" WEST, A DISTANCE OF 12.74 FEET TO THE BEGINNING OF A TANGENT CURVE CONCAVE EASTERLY HAVING A RADIUS OF 5.00 FEET;

THENCE SOUTHERLY ALONG SAID CURVE THROUGH A CENTRAL ANGLE OF 85°16'03", AN ARC LENGTH OF 7.44 FEET;

THENCE SOUTH 51°46'38" EAST, A DISTANCE OF 11.32 FEET TO THE BEGINNING OF A NON-TANGENT CURVE CONCAVE NORTHEASTERLY HAVING A RADIUS OF 524.50 FEET, THE RADIUS POINT OF SAID CURVE BEARS NORTH 35°10'05" EAST;

THENCE SOUTHEASTERLY ALONG SAID CURVE THROUGH A CENTRAL ANGLE OF 19°29'10", AN ARC LENGTH OF 178.38 FEET;

THENCE SOUTH 74°19'05" EAST, A DISTANCE OF 526.32 FEET TO THE BEGINNING OF A TANGENT CURVE CONCAVE NORTHWESTERLY HAVING A RADIUS OF 5.00 FEET;

THENCE NORTHEASTERLY ALONG SAID CURVE THROUGH A CENTRAL ANGLE OF 90°00'00", AN ARC LENGTH OF 7.85 FEET;

THENCE NORTH 15°40'55" EAST, A DISTANCE OF 23.50 FEET;

THENCE SOUTH 74°19'05" EAST, A DISTANCE OF 71.00 FEET;

THENCE SOUTH 15°40'55" WEST, A DISTANCE OF 23.50 FEET TO THE BEGINNING OF A TANGENT CURVE CONCAVE NORTHEASTERLY HAVING A RADIUS OF 5.00 FEET;

THENCE SOUTHEASTERLY ALONG SAID CURVE THROUGH A CENTRAL ANGLE OF 90°00'00", AN ARC LENGTH OF 7.85 FEET;

THENCE SOUTH 74°19'05" EAST, A DISTANCE OF 306.28 FEET;

THENCE SOUTH 15°40'55" WEST, A DISTANCE OF 91.00 FEET;

THENCE SOUTH 74°19'05" EAST, A DISTANCE OF 83.93 FEET;

THENCE SOUTH 03°23'27" EAST, A DISTANCE OF 178.09 FEET;

THENCE SOUTH 17°16'47" WEST, A DISTANCE OF 379.29 FEET TO THE BEGINNING OF A NON-TANGENT CURVE CONCAVE NORTHERLY HAVING A RADIUS OF 1,020.50 FEET, THE RADIUS POINT OF SAID CURVE BEARS NORTH 08°42'40" EAST;

THENCE EASTERLY ALONG SAID CURVE THROUGH A CENTRAL ANGLE OF 17°47'03", AN ARC LENGTH OF 316.75 FEET TO THE BEGINNING OF A COMPOUND CURVE CONCAVE NORTHWESTERLY HAVING A RADIUS OF 16.50 FEET;

THENCE NORTHEASTERLY ALONG SAID CURVE THROUGH A CENTRAL ANGLE OF 91°57'30", AN ARC LENGTH OF 26.48 FEET;

THENCE NORTH 11°01'53" WEST, A DISTANCE OF 23.72 FEET;

THENCE NORTH 77°18'48" EAST, A DISTANCE OF 71.03 FEET;

THENCE SOUTH 11°02'25" EAST, A DISTANCE OF 23.94 FEET TO THE BEGINNING OF A TANGENT CURVE CONCAVE NORTHEASTERLY HAVING A RADIUS OF 16.50 FEET;

THENCE SOUTHEASTERLY ALONG SAID CURVE THROUGH A CENTRAL ANGLE OF 93°58'18", AN ARC LENGTH OF 27.06 FEET TO THE BEGINNING OF A COMPOUND CURVE CONCAVE NORTHWESTERLY HAVING A RADIUS OF 1,020.50 FEET;

THENCE NORTHEASTERLY ALONG SAID CURVE THROUGH A CENTRAL ANGLE OF 22°59'34", AN ARC LENGTH OF 409.53 FEET TO THE BEGINNING OF A COMPOUND CURVE CONCAVE WESTERLY HAVING A RADIUS OF 16.50 FEET;

THENCE NORTHERLY ALONG SAID CURVE THROUGH A CENTRAL ANGLE OF 94°34'30", AN ARC LENGTH OF 27.24 FEET;

THENCE NORTH 42°34'46" WEST, A DISTANCE OF 18.48 FEET;

THENCE NORTH 47°25'14" EAST, A DISTANCE OF 91.00 FEET;

THENCE SOUTH 42°34'46" EAST, A DISTANCE OF 20.92 FEET TO THE BEGINNING OF A TANGENT CURVE CONCAVE NORTHERLY HAVING A RADIUS OF 16.50 FEET;

THENCE EASTERLY ALONG SAID CURVE THROUGH A CENTRAL ANGLE OF 93°40'39", AN ARC LENGTH OF 26.98 FEET;

THENCE NORTH 43°44'34" EAST, A DISTANCE OF 159.57 FEET TO THE BEGINNING OF A TANGENT CURVE CONCAVE NORTHWESTERLY HAVING A RADIUS OF 560.50 FEET;

THENCE NORTHEASTERLY ALONG SAID CURVE THROUGH A CENTRAL ANGLE OF 24°17'55", AN ARC LENGTH OF 237.70 FEET TO THE BEGINNING OF A COMPOUND CURVE CONCAVE WESTERLY HAVING A RADIUS OF 181.50 FEET;

THENCE NORTHERLY ALONG SAID CURVE THROUGH A CENTRAL ANGLE OF 09°46'23", AN ARC LENGTH OF 30.96 FEET;

THENCE NORTH 09°40'16" EAST, A DISTANCE OF 64.79 FEET TO THE BEGINNING OF A TANGENT CURVE CONCAVE WESTERLY HAVING A RADIUS OF 555.00 FEET;

THENCE NORTHERLY ALONG SAID CURVE THROUGH A CENTRAL ANGLE OF 03°16'12", AN ARC LENGTH OF 31.67 FEET;

THENCE NORTH 82°19'19" WEST, A DISTANCE OF 20.70 FEET;

THENCE NORTH 07°40'41" EAST, A DISTANCE OF 29.33 FEET TO THE SOUTHERLY RIGHT-OF-WAY OF RIDGEGATE PARKWAY AND THE BEGINNING OF A NON-TANGENT CURVE CONCAVE NORTHERLY HAVING A RADIUS OF 1,153.50 FEET, THE RADIUS POINT OF SAID CURVE BEARS NORTH 07°39'08" EAST;

THENCE ALONG SAID SOUTHERLY RIGHT-OF-WAY, EASTERLY ALONG SAID CURVE THROUGH A CENTRAL ANGLE OF 05°55'23", AN ARC LENGTH OF 119.25 FEET TO THE BEGINNING OF A NON-TANGENT CURVE CONCAVE WESTERLY HAVING A RADIUS OF 655.00 FEET, THE RADIUS POINT OF SAID CURVE BEARS NORTH 86°33'23" WEST;

THENCE DEPARTING SAID SOUTHERLY RIGHT-OF-WAY, SOUTHERLY ALONG SAID CURVE THROUGH A CENTRAL ANGLE OF 13°19'48", AN ARC LENGTH OF 152.39 FEET TO THE BEGINNING OF A COMPOUND CURVE CONCAVE WESTERLY HAVING A RADIUS OF 218.00 FEET;

THENCE SOUTHERLY ALONG SAID CURVE THROUGH A CENTRAL ANGLE OF 15°21'33", AN ARC LENGTH OF 58.57;

THENCE SOUTH 32°07'58" WEST, A DISTANCE OF 116.05 FEET TO THE BEGINNING OF A TANGENT CURVE CONCAVE NORTHWESTERLY HAVING A RADIUS OF 639.50 FEET;

THENCE SOUTHWESTERLY ALONG SAID CURVE THROUGH A CENTRAL ANGLE OF $11^{\circ}36'36''$, AN ARC LENGTH OF 129.58 FEET;

THENCE SOUTH $43^{\circ}44'34''$ WEST, A DISTANCE OF 138.60 FEET TO THE BEGINNING OF A TANGENT CURVE CONCAVE NORTHWESTERLY HAVING A RADIUS OF 1,099.50 FEET;

THENCE SOUTHWESTERLY ALONG SAID CURVE THROUGH A CENTRAL ANGLE OF $01^{\circ}56'09''$, AN ARC LENGTH OF 37.15 FEET TO THE BEGINNING OF A REVERSE CURVE CONCAVE EASTERLY HAVING A RADIUS OF 16.50 FEET;

THENCE SOUTHERLY ALONG SAID CURVE THROUGH A CENTRAL ANGLE OF $88^{\circ}15'30''$, AN ARC LENGTH OF 25.42 FEET;

THENCE SOUTH $42^{\circ}34'46''$ EAST, A DISTANCE OF 21.48 FEET;

THENCE SOUTH $47^{\circ}25'14''$ WEST, A DISTANCE OF 71.00 FEET;

THENCE NORTH $42^{\circ}34'46''$ WEST, A DISTANCE OF 22.23 FEET TO THE BEGINNING OF A TANGENT CURVE CONCAVE SOUTHERLY HAVING A RADIUS OF 17.50 FEET;

THENCE WESTERLY ALONG SAID CURVE THROUGH A CENTRAL ANGLE OF $86^{\circ}32'58''$, AN ARC LENGTH OF 26.44 FEET TO THE BEGINNING OF A REVERSE CURVE CONCAVE NORTHWESTERLY HAVING A RADIUS OF 1,099.50 FEET;

THENCE SOUTHWESTERLY ALONG SAID CURVE THROUGH A CENTRAL ANGLE OF $24^{\circ}06'37''$, AN ARC LENGTH OF 462.67 FEET TO THE BEGINNING OF A REVERSE CURVE CONCAVE SOUTHEASTERLY HAVING A RADIUS OF 16.50 FEET;

THENCE SOUTHWESTERLY ALONG SAID CURVE THROUGH A CENTRAL ANGLE OF $86^{\circ}12'57''$, AN ARC LENGTH OF 24.83 FEET;

THENCE SOUTH $11^{\circ}02'00''$ EAST, A DISTANCE OF 23.47 FEET;

THENCE SOUTH $78^{\circ}58'00''$ WEST, A DISTANCE OF 79.00 FEET;

THENCE NORTH $11^{\circ}02'00''$ WEST, A DISTANCE OF 21.70 FEET TO THE BEGINNING OF A TANGENT CURVE CONCAVE SOUTHWESTERLY HAVING A RADIUS OF 16.50 FEET;

THENCE NORTHWESTERLY ALONG SAID CURVE THROUGH A CENTRAL ANGLE OF $88^{\circ}01'51''$, AN ARC LENGTH OF 25.35 FEET TO THE BEGINNING OF A REVERSE CURVE CONCAVE NORTHERLY HAVING A RADIUS OF 1,099.50 FEET;

THENCE WESTERLY ALONG SAID CURVE THROUGH A CENTRAL ANGLE OF $18^{\circ}23'59''$, AN ARC LENGTH OF 353.09 FEET;

THENCE SOUTH $17^{\circ}16'42''$ WEST, A DISTANCE OF 460.69 FEET;

THENCE SOUTH $41^{\circ}46'08''$ EAST, A DISTANCE OF 52.11 FEET TO THE BEGINNING OF A NON-TANGENT CURVE CONCAVE SOUTHEASTERLY HAVING A RADIUS OF 425.00 FEET, THE RADIUS POINT OF SAID CURVE BEARS SOUTH $49^{\circ}32'40''$ EAST;

THENCE SOUTHWESTERLY ALONG SAID CURVE THROUGH A CENTRAL ANGLE OF $02^{\circ}13'10''$, AN ARC LENGTH OF 16.46 FEET;

THENCE SOUTH $38^{\circ}14'10''$ WEST, A DISTANCE OF 474.17 FEET TO THE BEGINNING OF A TANGENT CURVE CONCAVE NORTHERLY HAVING A RADIUS OF 18.00 FEET;

THENCE WESTERLY ALONG SAID CURVE THROUGH A CENTRAL ANGLE OF 89°38'20", AN ARC LENGTH OF 28.16 FEET;

THENCE NORTH 52°07'30" WEST, A DISTANCE OF 157.43 FEET;

THENCE NORTH 37°52'30" EAST, A DISTANCE OF 96.00 FEET;

THENCE NORTH 07°07'30" WEST, A DISTANCE OF 14.14 FEET;

THENCE NORTH 52°07'30" WEST, A DISTANCE OF 447.46 FEET;

THENCE NORTH 15°40'55" EAST, A DISTANCE OF 346.80 FEET;

THENCE NORTH 74°58'38" WEST, A DISTANCE OF 223.24 FEET;

THENCE SOUTH 13°42'56" WEST, A DISTANCE OF 96.64 FEET;

THENCE SOUTH 50°37'27" WEST, A DISTANCE OF 13.73 FEET TO THE BEGINNING OF A NON-TANGENT CURVE CONCAVE NORTHERLY HAVING A RADIUS OF 53.00 FEET, THE RADIUS POINT OF SAID CURVE BEARS SOUTH 50°37'27" WEST;

THENCE WESTERLY ALONG SAID CURVE THROUGH A CENTRAL ANGLE OF 220°53'41", AN ARC LENGTH OF 204.33 FEET TO THE BEGINNING OF A REVERSE CURVE CONCAVE SOUTHWESTERLY HAVING A RADIUS OF 18.00 FEET;

THENCE NORTHWESTERLY ALONG SAID CURVE THROUGH A CENTRAL ANGLE OF 77°48'12", AN ARC LENGTH OF 24.44 FEET;

THENCE NORTH 76°17'04" WEST, A DISTANCE OF 83.25 FEET;

THENCE SOUTH 13°42'56" WEST, A DISTANCE OF 58.99 FEET;

THENCE SOUTH 75°15'09" WEST, A DISTANCE OF 366.22 FEET;

THENCE SOUTH 51°22'27" WEST, A DISTANCE OF 276.27 FEET;

THENCE NORTH 30°39'49" WEST, A DISTANCE OF 101.63 FEET;

THENCE SOUTH 60°42'26" WEST, A DISTANCE OF 49.33 FEET;

THENCE NORTH 72°30'19" WEST, A DISTANCE OF 14.11 FEET;

THENCE SOUTH 64°37'07" WEST, A DISTANCE OF 70.72 FEET;

THENCE SOUTH 21°44'32" WEST, A DISTANCE OF 14.11 FEET;

THENCE SOUTH 68°43'05" WEST, A DISTANCE OF 56.09 FEET;

THENCE SOUTH 47°57'53" WEST, A DISTANCE OF 73.48 FEET;

THENCE SOUTH 09°37'05" WEST, A DISTANCE OF 17.36 FEET;

THENCE NORTH 80°22'55" WEST, A DISTANCE OF 111.00 FEET;

THENCE NORTH 09°37'12" EAST, A DISTANCE OF 61.46 FEET;

THENCE NORTH 80°23'30" WEST, A DISTANCE OF 50.00 FEET;

THENCE NORTH 09°37'05" EAST, A DISTANCE OF 12.00 FEET TO THE BEGINNING OF A TANGENT CURVE CONCAVE SOUTHWESTERLY HAVING A RADIUS OF 18.00 FEET;

THENCE NORTHWESTERLY ALONG SAID CURVE THROUGH A CENTRAL ANGLE OF 107°18'43", AN ARC LENGTH OF 33.71 FEET TO THE BEGINNING OF A REVERSE CURVE CONCAVE NORTHERLY HAVING A RADIUS OF 925.00 FEET;

THENCE WESTERLY ALONG SAID CURVE THROUGH A CENTRAL ANGLE OF 11°33'13", AN ARC LENGTH OF 186.53 FEET TO THE BEGINNING OF A REVERSE CURVE CONCAVE SOUTHEASTERLY HAVING A RADIUS OF 18.00 FEET;

THENCE SOUTHWESTERLY ALONG SAID CURVE THROUGH A CENTRAL ANGLE OF 84°14'31", AN ARC LENGTH OF 26.47 FEET;

THENCE SOUTH 09°37'05" WEST, A DISTANCE OF 16.72 FEET;

THENCE NORTH 80°22'55" WEST, A DISTANCE OF 50.00 FEET;

THENCE NORTH 09°28'33" EAST, A DISTANCE OF 12.04 FEET TO THE BEGINNING OF A TANGENT CURVE CONCAVE SOUTHWESTERLY HAVING A RADIUS OF 18.00 FEET;

THENCE NORTHWESTERLY ALONG SAID CURVE THROUGH A CENTRAL ANGLE OF 90°22'44", AN ARC LENGTH OF 28.39 FEET TO THE BEGINNING OF A REVERSE CURVE CONCAVE NORTHERLY HAVING A RADIUS OF 925.00 FEET;

THENCE WESTERLY ALONG SAID CURVE THROUGH A CENTRAL ANGLE OF 00°31'17", AN ARC LENGTH OF 8.42 FEET;

THENCE NORTH 80°22'55" WEST, A DISTANCE OF 86.21 FEET;

THENCE SOUTH 42°37'17" WEST, A DISTANCE OF 25.11 FEET;

THENCE SOUTH 09°37'05" WEST, A DISTANCE OF 13.94 FEET;

THENCE NORTH 80°23'00" WEST, A DISTANCE OF 91.00 FEET TO THE POINT OF BEGINNING.

CONTAINING AN AREA OF 186.063 ACRES, (8,104,894 SQUARE FEET), MORE OR LESS.

BUT, EXCEPTING THEREFROM:

Tract CZ,
RidgeGate SW Village Filing No. 1
City of Lone Tree,
County of Douglas,
State of Colorado
(containing 0.742 acres, more or less)

AND

PART SE1/4 NE1/4 23-6-67 Lying SE of TRACT AJ,
RidgeGate SW Village Filing No. 1
City of Lone Tree,
County of Douglas,
State of Colorado
(containing 1.003 acres, more or less)

CONTAINING AN AREA OF 184.320 ACRES, MORE OR LESS.

AND

Legal Description

**RIDGEGATE SW VILLAGE FILING NO. 2 PLAT BOUNDARY
LEGAL DESCRIPTION**

A PARCEL OF LAND BEING THAT CERTAIN BARGAIN AND SALE DEED RECORDED AT RECEPTION NO. 2021080209 IN THE OFFICIAL RECORDS OF THE DOUGLAS COUNTY, COLORADO CLERK AND RECORDER'S OFFICE, TOGETHER WITH AN UNPLATTED PARCEL OF LAND, BOTH PARCELS LOCATED IN THE SOUTHEAST QUARTER OF SECTION 22, SECTION 23 AND THE SOUTHWEST QUARTER OF SECTION 24, ALL IN TOWNSHIP 6 SOUTH, RANGE 67 WEST OF THE SIXTH PRINCIPAL MERIDIAN, CITY OF LONE TREE, COUNTY OF DOUGLAS, STATE OF COLORADO, BEING MORE PARTICULARLY DESCRIBED AS FOLLOWS:

BASIS OF BEARINGS: THE SOUTH LINE OF THE NORTHWEST QUARTER OF SECTION 23, TOWNSHIP 6 SOUTH, RANGE 67 WEST OF THE SIXTH PRINCIPAL MERIDIAN, WAS ASSUMED TO BEAR NORTH 89°40'23" EAST, A DISTANCE OF 2,636.47 FEET, BEING MONUMENTED AT THE WEST QUARTER CORNER OF SAID SECTION 23 BY A 1-1/2" BRASS CAP IN 6" CONCRETE, 0.3' ABOVE GROUND, NO MARKINGS OBSERVED ON CAP AND AT THE CENTER QUARTER CORNER OF SAID SECTION 23 BY A 10" X 6" X 8" STONE WITH A CUT CROSS.

OVERALL BOUNDARY PARCEL

BEGINNING AT THE WEST QUARTER CORNER OF SAID SECTION 23;

THENCE ALONG THE SOUTH LINE OF THE NORTHWEST QUARTER OF SAID SECTION 23, NORTH 89°40'23" EAST, A DISTANCE OF 407.06 FEET TO THE BOUNDARY OF THAT CERTAIN USE RESTRICTION RECORDED AT RECEPTION NO. 2020011022 IN SAID OFFICIAL RECORDS;

THENCE ALONG THE BOUNDARY OF SAID USE RESTRICTION, THE FOLLOWING THREE (3) COURSES:

1. NORTH 43°32'45" EAST, A DISTANCE OF 326.90 FEET;
2. NORTH 75°08'07" EAST, A DISTANCE OF 150.09 FEET;
3. NORTH 53°25'24" EAST, A DISTANCE OF 458.16 FEET TO THE SOUTHERLY BOUNDARY OF RIDGEGATE SW VILLAGE FILING NO. 1 RECORDED AT RECEPTION NO. 2021076801 IN SAID OFFICIAL RECORDS;

THENCE ALONG SAID SOUTHERLY BOUNDARY, THE FOLLOWING THIRTY-SEVEN (37) COURSES:

1. SOUTH 13°27'03" EAST, A DISTANCE OF 93.54 FEET;
2. NORTH 76°32'57" EAST, A DISTANCE OF 440.26 FEET TO THE BEGINNING OF A TANGENT CURVE CONCAVE SOUTHERLY HAVING A RADIUS OF 636.86 FEET;
3. EASTERLY ALONG SAID CURVE THROUGH A CENTRAL ANGLE OF 29°56'06", AN ARC LENGTH OF 332.74 FEET;
4. NORTH 16°16'23" EAST, A DISTANCE OF 255.80 FEET;
5. SOUTH 73°08'32" EAST, A DISTANCE OF 88.78 FEET TO THE BEGINNING OF A NON-TANGENT CURVE CONCAVE NORTHEASTERLY HAVING A RADIUS OF 62.00 FEET, THE RADIUS POINT OF SAID CURVE BEARS SOUTH 73°08'09" EAST;
6. SOUTHEASTERLY ALONG SAID CURVE THROUGH A CENTRAL ANGLE OF 90°00'00", AN ARC LENGTH OF 97.39 FEET;

7. SOUTH 73°08'09" EAST, A DISTANCE OF 621.97 FEET TO THE BEGINNING OF A TANGENT CURVE CONCAVE SOUTHWESTERLY HAVING A RADIUS OF 22.00 FEET;
8. SOUTHEASTERLY ALONG SAID CURVE THROUGH A CENTRAL ANGLE OF 84°27'18", AN ARC LENGTH OF 32.43 FEET TO THE BEGINNING OF A REVERSE CURVE CONCAVE EASTERLY HAVING A RADIUS OF 745.50 FEET;
9. SOUTHERLY ALONG SAID CURVE THROUGH A CENTRAL ANGLE OF 01°42'04", AN ARC LENGTH OF 22.13 FEET;
10. SOUTH 09°37'05" WEST, A DISTANCE OF 318.79 FEET;
11. SOUTH 80°23'00" EAST, A DISTANCE OF 91.00 FEET;
12. NORTH 09°37'05" EAST, A DISTANCE OF 13.94 FEET;
13. NORTH 42°37'17" EAST, A DISTANCE OF 25.11 FEET;
14. SOUTH 80°22'55" EAST, A DISTANCE OF 86.21 FEET TO THE BEGINNING OF A TANGENT CURVE CONCAVE NORTHERLY HAVING A RADIUS OF 925.00 FEET;
15. EASTERLY ALONG SAID CURVE THROUGH A CENTRAL ANGLE OF 00°31'23", AN ARC LENGTH OF 8.45 FEET TO THE BEGINNING OF A REVERSE CURVE CONCAVE SOUTHWESTERLY HAVING A RADIUS OF 18.00 FEET;
16. SOUTHEASTERLY ALONG SAID CURVE THROUGH A CENTRAL ANGLE OF 90°31'23", AN ARC LENGTH OF 28.44 FEET;
17. SOUTH 09°37'05" WEST, A DISTANCE OF 12.00 FEET;
18. SOUTH 80°22'55" EAST, A DISTANCE OF 50.00 FEET;
19. NORTH 09°37'05" EAST, A DISTANCE OF 16.72 FEET TO THE BEGINNING OF A TANGENT CURVE CONCAVE SOUTHEASTERLY HAVING A RADIUS OF 18.00 FEET;
20. NORTHEASTERLY ALONG SAID CURVE THROUGH A CENTRAL ANGLE OF 84°14'31", AN ARC LENGTH OF 26.47 FEET TO THE BEGINNING OF A REVERSE CURVE CONCAVE NORTHERLY HAVING A RADIUS OF 925.00 FEET;
21. EASTERLY ALONG SAID CURVE THROUGH A CENTRAL ANGLE OF 11°33'13", AN ARC LENGTH OF 186.53 FEET TO THE BEGINNING OF A REVERSE CURVE CONCAVE SOUTHWESTERLY HAVING A RADIUS OF 18.00 FEET;
22. SOUTHEASTERLY ALONG SAID CURVE THROUGH A CENTRAL ANGLE OF 107°18'43", AN ARC LENGTH OF 33.71 FEET;
23. SOUTH 09°36'30" WEST, A DISTANCE OF 12.00 FEET;
24. SOUTH 80°23'30" EAST, A DISTANCE OF 50.00 FEET;
25. SOUTH 09°37'12" WEST, A DISTANCE OF 61.46 FEET;
26. SOUTH 80°22'55" EAST, A DISTANCE OF 111.00 FEET;
27. NORTH 77°42'30" EAST, A DISTANCE OF 293.92 FEET;
28. NORTH 51°22'27" EAST, A DISTANCE OF 276.27 FEET;

29. NORTH 75°15'09" EAST, A DISTANCE OF 366.22 FEET;
30. NORTH 13°42'56" EAST, A DISTANCE OF 58.99 FEET;
31. SOUTH 76°17'04" EAST, A DISTANCE OF 83.25 FEET TO THE BEGINNING OF A TANGENT CURVE CONCAVE SOUTHWESTERLY HAVING A RADIUS OF 18.00 FEET;
32. SOUTHEASTERLY ALONG SAID CURVE THROUGH A CENTRAL ANGLE OF 77°48'12", AN ARC LENGTH OF 24.44 FEET TO THE BEGINNING OF A REVERSE CURVE CONCAVE NORTHERLY HAVING A RADIUS OF 53.00 FEET;
33. EASTERLY ALONG SAID CURVE THROUGH A CENTRAL ANGLE OF 220°53'41", AN ARC LENGTH OF 204.33 FEET;
34. NORTH 50°37'27" EAST, A DISTANCE OF 13.73 FEET;
35. NORTH 13°42'56" EAST, A DISTANCE OF 96.64 FEET;
36. SOUTH 74°58'38" EAST, A DISTANCE OF 223.24 FEET;
37. SOUTH 15°40'55" WEST, A DISTANCE OF 124.18 FEET;

THENCE DEPARTING SAID SOUTHERLY BOUNDARY, SOUTH 65°35'08" WEST, A DISTANCE OF 316.55 FEET TO THE BOUNDARY OF THAT CERTAIN CONSERVATION EASEMENT 4 RECORDED AT RECEPTION NO. 2018048531 IN SAID OFFICIAL RECORDS;

THENCE ALONG THE BOUNDARY OF SAID CONSERVATION EASEMENT 4, SOUTH 44°08'49" WEST, A DISTANCE OF 499.60 FEET;

THENCE DEPARTING THE BOUNDARY OF SAID CONSERVATION EASEMENT 4, SOUTH 34°59'22" WEST, A DISTANCE OF 242.96 FEET;

THENCE SOUTH 02°01'35" WEST, A DISTANCE OF 376.21 FEET;

THENCE SOUTH 11°53'25" EAST, A DISTANCE OF 468.80 FEET;

THENCE SOUTH 19°12'20" WEST, A DISTANCE OF 811.65 FEET;

THENCE SOUTH 62°21'40" WEST, A DISTANCE OF 242.18 FEET;

THENCE NORTH 90°00'00" WEST, A DISTANCE OF 83.49 FEET;

THENCE NORTH 00°00'04" WEST, A DISTANCE OF 98.51 FEET;

THENCE SOUTH 89°59'56" WEST, A DISTANCE OF 250.00 FEET;

THENCE SOUTH 00°00'04" EAST, A DISTANCE OF 415.51 FEET TO THE BOUNDARY OF THAT CERTAIN BARGAIN AND SALE DEED RECORDED AT RECEPTION NO. 2021080209 IN SAID OFFICIAL RECORDS;

THENCE ALONG THE BOUNDARY OF SAID BARGAIN AND SALE DEED, THE FOLLOWING TWENTY-SEVEN (27) COURSES:

1. NORTH 89°32'02" EAST, A DISTANCE OF 1,912.04 FEET;
2. NORTH 32°55'33" EAST, A DISTANCE OF 17.94 FEET TO THE BEGINNING OF A TANGENT CURVE CONCAVE WESTERLY HAVING A RADIUS OF 135.00 FEET;

3. NORTHERLY ALONG SAID CURVE THROUGH A CENTRAL ANGLE OF 37°36'23", AN ARC LENGTH OF 88.61 FEET;
4. NORTH 04°40'49" WEST, A DISTANCE OF 32.84 FEET TO THE BEGINNING OF A TANGENT CURVE CONCAVE SOUTHEASTERLY HAVING A RADIUS OF 132.00 FEET;
5. NORTHEASTERLY ALONG SAID CURVE THROUGH A CENTRAL ANGLE OF 94°18'25", AN ARC LENGTH OF 217.27 FEET;
6. NORTH 89°37'35" EAST, A DISTANCE OF 123.20 FEET TO THE BEGINNING OF A TANGENT CURVE CONCAVE SOUTHWESTERLY HAVING A RADIUS OF 72.00 FEET;
7. SOUTHEASTERLY ALONG SAID CURVE THROUGH A CENTRAL ANGLE OF 97°43'48", AN ARC LENGTH OF 122.81 FEET;
8. SOUTH 07°21'23" WEST, A DISTANCE OF 49.27 FEET TO THE BEGINNING OF A TANGENT CURVE CONCAVE EASTERLY HAVING A RADIUS OF 20.00 FEET;
9. SOUTHEASTERLY ALONG SAID CURVE THROUGH A CENTRAL ANGLE OF 59°06'38", AN ARC LENGTH OF 20.63 FEET;
10. SOUTH 51°45'15" EAST, A DISTANCE OF 139.27 FEET;
11. SOUTH 37°59'49" EAST, A DISTANCE OF 45.98 FEET;
12. NORTH 89°16'29" EAST, A DISTANCE OF 239.48 FEET;
13. NORTH 71°49'53" EAST, A DISTANCE OF 154.88 FEET TO THE BEGINNING OF A TANGENT CURVE CONCAVE NORTHWESTERLY HAVING A RADIUS OF 500.00 FEET;
14. NORTHEASTERLY ALONG SAID CURVE THROUGH A CENTRAL ANGLE OF 34°23'25", AN ARC LENGTH OF 300.11 FEET;
15. NORTH 37°26'28" EAST, A DISTANCE OF 138.10 FEET TO THE BEGINNING OF A TANGENT CURVE CONCAVE SOUTHEASTERLY HAVING A RADIUS OF 280.00 FEET;
16. NORTHEASTERLY ALONG SAID CURVE THROUGH A CENTRAL ANGLE OF 59°54'41", AN ARC LENGTH OF 292.78 FEET TO THE BEGINNING OF A REVERSE CURVE CONCAVE NORTHERLY HAVING A RADIUS OF 1,150.00 FEET;
17. EASTERLY ALONG SAID CURVE THROUGH A CENTRAL ANGLE OF 13°51'47", AN ARC LENGTH OF 278.25 FEET TO THE BEGINNING OF A REVERSE CURVE CONCAVE SOUTHERLY HAVING A RADIUS OF 175.00 FEET;
18. EASTERLY ALONG SAID CURVE THROUGH A CENTRAL ANGLE OF 40°30'41", AN ARC LENGTH OF 123.74 FEET;
19. SOUTH 55°59'56" EAST, A DISTANCE OF 45.42 FEET TO THE BEGINNING OF A TANGENT CURVE CONCAVE SOUTHWESTERLY HAVING A RADIUS OF 120.00 FEET;
20. SOUTHEASTERLY ALONG SAID CURVE THROUGH A CENTRAL ANGLE OF 23°44'45", AN ARC LENGTH OF 49.73 FEET;
21. SOUTH 32°15'11" EAST, A DISTANCE OF 146.86 FEET TO THE BEGINNING OF A TANGENT CURVE CONCAVE NORTHEASTERLY HAVING A RADIUS OF 700.00 FEET;
22. SOUTHEASTERLY ALONG SAID CURVE THROUGH A CENTRAL ANGLE OF 16°30'03", AN ARC LENGTH OF 201.60 FEET;

23. SOUTH 48°45'15" EAST, A DISTANCE OF 119.65 FEET;
24. SOUTH 89°16'25" WEST, A DISTANCE OF 1,949.39 FEET;
25. SOUTH 89°31'58" WEST, A DISTANCE OF 2,634.16 FEET;
26. SOUTH 89°48'21" WEST, A DISTANCE OF 2,615.05 FEET;
27. SOUTH 89°27'33" WEST, A DISTANCE OF 1,104.07 FEET TO THE BOUNDARY OF SAID CONSERVATION EASEMENT 4 RECORDED AT RECEPTION NO. 2018048531;

THENCE ALONG THE BOUNDARY OF SAID CONSERVATION EASEMENT 4, THE FOLLOWING SIX (6) COURSES:

1. NORTH 15°19'30" EAST, A DISTANCE OF 150.93 FEET;
2. NORTH 15°45'29" EAST, A DISTANCE OF 44.29 FEET TO THE BEGINNING OF A NON-TANGENT CURVE CONCAVE EASTERLY HAVING A RADIUS OF 2,930.00 FEET, THE RADIUS POINT OF SAID CURVE BEARS SOUTH 73°48'32" EAST;
3. NORTHERLY ALONG SAID CURVE THROUGH A CENTRAL ANGLE OF 01°45'36", AN ARC LENGTH OF 90.00 FEET TO THE BEGINNING OF A COMPOUND CURVE CONCAVE EASTERLY HAVING A RADIUS OF 2,930.00 FEET;
4. NORTHERLY ALONG SAID CURVE THROUGH A CENTRAL ANGLE OF 03°30'38", AN ARC LENGTH OF 179.52 FEET;
5. NORTH 21°27'42" EAST, A DISTANCE OF 1,132.17 FEET;
6. NORTH 17°12'38" EAST, A DISTANCE OF 981.74 FEET TO THE SOUTH LINE OF THE NORTHEAST QUARTER OF SAID SECTION 22;

THENCE ALONG SAID SOUTH LINE, NORTH 89°59'26" EAST, A DISTANCE OF 235.73 FEET TO THE **POINT OF BEGINNING**.

CONTAINING A GROSS AREA OF 288.592 ACRES, (12,571,082 SQUARE FEET), MORE OR LESS.

EXCEPTING THEREFROM THE FOLLOWING DESCRIBED PARCEL OF LAND:

COMMENCING AT THE WEST QUARTER CORNER OF SAID SECTION 23;

THENCE SOUTH 58°23'17" EAST, A DISTANCE OF 1,325.70 FEET TO THE **POINT OF BEGINNING**;

THENCE SOUTH 75°39'30" EAST, A DISTANCE OF 95.96 FEET;

THENCE SOUTH 14°20'30" WEST, A DISTANCE OF 10.87 FEET;

THENCE SOUTH 75°39'30" EAST, A DISTANCE OF 50.00 FEET;

THENCE NORTH 14°20'30" EAST, A DISTANCE OF 10.28 FEET;

THENCE SOUTH 79°28'18" EAST, A DISTANCE OF 75.25 FEET;

THENCE SOUTH 82°48'06" EAST, A DISTANCE OF 64.09 FEET;

THENCE SOUTH 86°16'23" EAST, A DISTANCE OF 64.46 FEET;

THENCE SOUTH 89°45'17" EAST, A DISTANCE OF 64.46 FEET;
THENCE NORTH 86°45'49" EAST, A DISTANCE OF 64.46 FEET;
THENCE NORTH 83°49'23" EAST, A DISTANCE OF 64.14 FEET;
THENCE SOUTH 78°42'04" EAST, A DISTANCE OF 81.50 FEET;
THENCE SOUTH 49°44'45" EAST, A DISTANCE OF 81.50 FEET;
THENCE NORTH 69°50'34" EAST, A DISTANCE OF 51.16 FEET;
THENCE SOUTH 13°27'03" EAST, A DISTANCE OF 292.63 FEET;
THENCE SOUTH 76°32'57" WEST, A DISTANCE OF 46.40 FEET;
THENCE SOUTH 13°27'03" EAST, A DISTANCE OF 50.00 FEET;
THENCE NORTH 76°32'57" EAST, A DISTANCE OF 5.29 FEET;
THENCE SOUTH 12°37'09" EAST, A DISTANCE OF 343.00 FEET;
THENCE SOUTH 00°11'39" EAST, A DISTANCE OF 601.50 FEET TO THE BOUNDARY OF SAID BARGAIN AND SALE DEED AS RECORDED AT RECEPTION NO. 2021080209 AND THE BEGINNING OF A NON-TANGENT CURVE CONCAVE SOUTHWESTERLY HAVING A RADIUS OF 540.00 FEET, THE RADIUS POINT OF SAID CURVE BEARS SOUTH 72°22'26" WEST;

THENCE ALONG SAID BOUNDARY, THE FOLLOWING TWENTY-TWO (22) COURSES:

1. NORTHWESTERLY ALONG SAID CURVE THROUGH A CENTRAL ANGLE OF 11°12'02", AN ARC LENGTH OF 105.56 FEET;
2. NORTH 28°49'36" WEST, A DISTANCE OF 48.59 FEET TO THE BEGINNING OF A TANGENT CURVE CONCAVE SOUTHWESTERLY HAVING A RADIUS OF 734.00 FEET;
3. NORTHWESTERLY ALONG SAID CURVE THROUGH A CENTRAL ANGLE OF 09°59'30", AN ARC LENGTH OF 128.00 FEET;
4. NORTH 38°49'06" WEST, A DISTANCE OF 57.26 FEET TO THE BEGINNING OF A TANGENT CURVE CONCAVE SOUTHWESTERLY HAVING A RADIUS OF 115.00 FEET;
5. NORTHWESTERLY ALONG SAID CURVE THROUGH A CENTRAL ANGLE OF 29°27'16", AN ARC LENGTH OF 59.12 FEET;
6. NORTH 68°16'26" WEST, A DISTANCE OF 171.98 FEET TO THE BEGINNING OF A TANGENT CURVE CONCAVE SOUTHERLY HAVING A RADIUS OF 160.00 FEET;
7. WESTERLY ALONG SAID CURVE THROUGH A CENTRAL ANGLE OF 30°05'04", AN ARC LENGTH OF 84.01 FEET;
8. SOUTH 81°38'25" WEST, A DISTANCE OF 49.16 FEET TO THE BEGINNING OF A TANGENT CURVE CONCAVE SOUTHERLY HAVING A RADIUS OF 445.00 FEET;
9. WESTERLY ALONG SAID CURVE THROUGH A CENTRAL ANGLE OF 21°41'54", AN ARC LENGTH OF 168.53 FEET;

10. SOUTH 59°56'32" WEST, A DISTANCE OF 80.78 FEET TO THE BEGINNING OF A TANGENT CURVE CONCAVE SOUTHEASTERLY HAVING A RADIUS OF 410.00 FEET;
11. SOUTHWESTERLY ALONG SAID CURVE THROUGH A CENTRAL ANGLE OF 37°10'37", AN ARC LENGTH OF 266.03 FEET;
12. SOUTH 22°45'57" WEST, A DISTANCE OF 83.14 FEET TO THE BEGINNING OF A TANGENT CURVE CONCAVE EASTERLY HAVING A RADIUS OF 190.00 FEET;
13. SOUTHERLY ALONG SAID CURVE THROUGH A CENTRAL ANGLE OF 22°16'27", AN ARC LENGTH OF 73.86 FEET;
14. SOUTH 00°29'28" WEST, A DISTANCE OF 264.51 FEET;
15. SOUTH 89°48'09" WEST, A DISTANCE OF 147.28 FEET TO THE BEGINNING OF A NON-TANGENT CURVE CONCAVE SOUTHWESTERLY HAVING A RADIUS OF 1,538.00 FEET, THE RADIUS POINT OF SAID CURVE BEARS SOUTH 39°59'43" WEST;
16. NORTHWESTERLY ALONG SAID CURVE THROUGH A CENTRAL ANGLE OF 10°54'01", AN ARC LENGTH OF 292.60 FEET TO THE BEGINNING OF A COMPOUND CURVE CONCAVE SOUTHERLY HAVING A RADIUS OF 178.00 FEET;
17. WESTERLY ALONG SAID CURVE THROUGH A CENTRAL ANGLE OF 30°21'13", AN ARC LENGTH OF 94.30 FEET;
18. SOUTH 75°18'01" WEST, A DISTANCE OF 88.85 FEET;
19. SOUTH 48°18'20" WEST, A DISTANCE OF 154.91 FEET;
20. SOUTH 44°19'09" WEST, A DISTANCE OF 90.24 FEET;
21. SOUTH 89°48'09" WEST, A DISTANCE OF 244.69 FEET;
22. SOUTH 89°27'50" WEST, A DISTANCE OF 60.62 FEET;

THENCE DEPARTING SAID BOUNDARY, NORTH 00°11'39" WEST, A DISTANCE OF 198.64 FEET;

THENCE NORTH 01°51'03" WEST, A DISTANCE OF 93.32 FEET;

THENCE NORTH 65°56'56" EAST, A DISTANCE OF 29.76 FEET TO THE BEGINNING OF A NON-TANGENT CURVE CONCAVE NORTHWESTERLY HAVING A RADIUS OF 559.50 FEET, THE RADIUS POINT OF SAID CURVE BEARS NORTH 24°36'04" WEST;

THENCE NORTHEASTERLY ALONG SAID CURVE THROUGH A CENTRAL ANGLE OF 40°27'28", AN ARC LENGTH OF 395.08 FEET;

THENCE NORTH 24°56'28" EAST, A DISTANCE OF 40.37 FEET;

THENCE NORTH 82°15'15" EAST, A DISTANCE OF 18.07 FEET TO THE BEGINNING OF A NON-TANGENT CURVE CONCAVE SOUTHWESTERLY HAVING A RADIUS OF 175.00 FEET, THE RADIUS POINT OF SAID CURVE BEARS SOUTH 40°26'41" WEST;

THENCE SOUTHEASTERLY ALONG SAID CURVE THROUGH A CENTRAL ANGLE OF 05°41'48", AN ARC LENGTH OF 17.40 FEET;

THENCE NORTH 46°08'29" EAST, A DISTANCE OF 50.00 FEET TO THE BEGINNING OF A NON-TANGENT CURVE CONCAVE SOUTHWESTERLY HAVING A RADIUS OF 225.00 FEET, THE RADIUS POINT OF SAID CURVE BEARS SOUTH 46°08'29" WEST;

THENCE NORTHWESTERLY ALONG SAID CURVE THROUGH A CENTRAL ANGLE OF 10°41'10", AN ARC LENGTH OF 41.96 FEET;

THENCE NORTH 35°27'19" EAST, A DISTANCE OF 204.19 FEET;

THENCE NORTH 12°38'03" EAST, A DISTANCE OF 133.68 FEET;

THENCE NORTH 19°07'56" EAST, A DISTANCE OF 65.42 FEET;

THENCE NORTH 24°48'15" EAST, A DISTANCE OF 58.27 FEET;

THENCE NORTH 24°56'28" EAST, A DISTANCE OF 387.42 FEET;

THENCE NORTH 71°31'50" EAST, A DISTANCE OF 15.12 FEET;

THENCE SOUTH 61°52'47" EAST, A DISTANCE OF 1.66 FEET;

THENCE NORTH 28°07'13" EAST, A DISTANCE OF 50.00 FEET;

THENCE NORTH 61°52'47" WEST, A DISTANCE OF 12.29 FEET;

THENCE NORTH 28°07'13" EAST, A DISTANCE OF 48.79 FEET;

THENCE NORTH 41°09'00" EAST, A DISTANCE OF 58.73 FEET TO THE BEGINNING OF A NON-TANGENT CURVE CONCAVE SOUTHERLY HAVING A RADIUS OF 454.50 FEET, THE RADIUS POINT OF SAID CURVE BEARS SOUTH 44°56'10" EAST;

THENCE EASTERLY ALONG SAID CURVE THROUGH A CENTRAL ANGLE OF 50°58'37", AN ARC LENGTH OF 404.38 FEET TO THE **POINT OF BEGINNING** FROM WHICH THE CENTER QUARTER CORNER OF SAID SECTION 23 BEARS NORTH 64°46'56" EAST, A DISTANCE OF 1,666.25 FEET.

CONTAINING A GROSS AREA OF 44.889 ACRES, (1,955,377 SQUARE FEET), MORE OR LESS.

CONTAINING A NET AREA OF 243.703 ACRES, (10,615,705 SQUARE FEET), MORE OR LESS.

BUT, EXCEPTING THEREFROM:

Tract CZ,
RidgeGate SW Village Filing No. 1
City of Lone Tree,
County of Douglas,
State of Colorado

AND

A PARCEL OF LAND BEING A PORTION OF THE NORTHEAST QUARTER OF SECTION 23 AND THE NORTHWEST QUARTER OF SECTION 24, TOWNSHIP 6 SOUTH, RANGE 67 WEST OF THE SIXTH PRINCIPAL MERIDIAN, CITY OF LONE TREE, COUNTY OF DOUGLAS, STATE OF COLORADO, BEING MORE PARTICULARLY DESCRIBED AS FOLLOWS:

BEARINGS ARE BASED UPON THE NORTH LINE OF THE NORTHEAST QUARTER OF SAID SECTION 23, AS BEARING S89°14'48"W A DISTANCE OF 2647.06 FEET BETWEEN THE NORTHEAST CORNER OF SAID SECTION 23, BEING A 1-1/2" BRASS CAP SET IN 6" CONCRETE AND THE NORTH QUARTER CORNER OF SAID SECTION 23, BEING A 1-1/2" BRASS CAP SET IN 6" CONCRETE.

COMMENCING AT THE NORTHEAST CORNER OF SAID SECTION 23;

THENCE S56°40'10"W A DISTANCE OF 833.27 FEET TO A POINT ON THE SOUTHWESTERLY RIGHT-OF-WAY LINE OF RIDGEGATE PARKWAY AS DESCRIBED IN THAT SPECIAL WARRANTY DEED RECORDED AT RECEPTION NO. 2010035810 IN THE OFFICE OF THE DOUGLAS COUNTY CLERK AND RECORDER, SAID POINT BEING THE POINT OF BEGINNING;

THENCE ALONG SAID SOUTHWESTERLY RIGHT-OF-WAY LINE, ALONG THE ARC OF A CURVE TO THE LEFT, HAVING A CENTRAL ANGLE OF 27°05'45", A RADIUS OF 1884.00 FEET, A CHORD BEARING S64°01'51"E A DISTANCE OF 882.69 FEET, AND AN ARC DISTANCE OF 890.97 FEET TO THE NORTHWESTERLY CORNER OF THAT SPECIAL WARRANTY DEED RECORDED AT RECEPTION NO. 2021076830 IN THE OFFICE OF THE DOUGLAS COUNTY CLERK AND RECORDER;

THENCE S03°23'27"E ALONG THE WESTERLY LINE OF SAID RECEPTION NO. 2021076830 A DISTANCE OF 588.45 FEET TO A POINT ON THE NORTHEASTERLY RIGHT-OF-WAY LINE OF OCTAVE AVENUE AS SHOWN ON RIDGEGATE SW VILLAGE FILING NO. 1, RECORDED AT RECEPTION NO. 2021076801 IN THE OFFICE OF THE DOUGLAS COUNTY CLERK AND RECORDER;

THENCE ALONG SAID NORTHEASTERLY RIGHT-OF-WAY LINE THE FOLLOWING TWENTY (20) COURSES:

1. N74°19'05"W TANGENT WITH THE FOLLOWING DESCRIBED CURVE A DISTANCE OF 252.96 FEET;
2. THENCE ALONG THE ARC OF A CURVE TO THE RIGHT, HAVING A CENTRAL ANGLE OF 90°00'00", A RADIUS OF 5.00 FEET, A CHORD BEARING N29°19'05"W A DISTANCE OF 7.07 FEET, AND AN ARC DISTANCE OF 7.85 FEET;
3. THENCE N15°40'55"E TANGENT WITH THE LAST DESCRIBED CURVE A DISTANCE OF 23.50 FEET;
4. THENCE N74°19'05"W A DISTANCE OF 71.00 FEET;
5. THENCE S15°40'55"W TANGENT WITH THE FOLLOWING DESCRIBED CURVE A DISTANCE OF 23.50 FEET;
6. THENCE ALONG THE ARC OF A CURVE TO THE RIGHT, HAVING A CENTRAL ANGLE OF 90°00'00", A RADIUS OF 5.00 FEET, A CHORD BEARING S60°40'55"W A DISTANCE OF 7.07 FEET, AND AN ARC DISTANCE OF 7.85 FEET;
7. THENCE N74°19'05"W TANGENT WITH THE LAST AND FOLLOWING DESCRIBED CURVES A DISTANCE OF 526.32 FEET;

8. THENCE ALONG THE ARC OF A CURVE TO THE RIGHT, HAVING A CENTRAL ANGLE OF 19°29'10", A RADIUS OF 524.50 FEET, A CHORD BEARING N64°34'30"W A DISTANCE OF 177.52 FEET, AND AN ARC DISTANCE OF 178.38 FEET;
9. THENCE N51°46'38"W NON-TANGENT WITH THE LAST DESCRIBED CURVE AND TANGENT WITH THE FOLLOWING DESCRIBED CURVE A DISTANCE OF 11.32 FEET;
10. THENCE ALONG THE ARC OF A CURVE TO THE RIGHT, HAVING A CENTRAL ANGLE OF 85°16'03", A RADIUS OF 5.00 FEET, A CHORD BEARING N09°08'37"W A DISTANCE OF 6.77 FEET, AND AN ARC DISTANCE OF 7.44 FEET;
11. THENCE N33°29'25"E TANGENT WITH THE LAST DESCRIBED CURVE A DISTANCE OF 12.74 FEET;
12. THENCE N41°02'36"E A DISTANCE OF 12.00 FEET;
13. THENCE N48°57'24"W A DISTANCE OF 71.00 FEET;
14. THENCE S41°02'36"W A DISTANCE OF 12.00 FEET;
15. THENCE S59°31'12"W A DISTANCE OF 10.33 FEET;
16. THENCE S88°26'54"W A DISTANCE OF 10.31 FEET;
17. THENCE N46°07'04"W NON-TANGENT WITH THE FOLLOWING DESCRIBED CURVE A DISTANCE OF 7.33 FEET;
18. THENCE ALONG THE ARC OF A CURVE TO THE RIGHT, HAVING A CENTRAL ANGLE OF 11°36'10", A RADIUS OF 524.50 FEET, A CHORD BEARING N37°16'48"W A DISTANCE OF 106.03 FEET, AND AN ARC DISTANCE OF 106.22 FEET;
19. THENCE N31°28'43"W TANGENT WITH THE LAST AND FOLLOWING DESCRIBED CURVES A DISTANCE OF 180.92 FEET;
20. THENCE ALONG THE ARC OF A CURVE TO THE RIGHT, HAVING A CENTRAL ANGLE OF 85°31'25", A RADIUS OF 5.00 FEET, A CHORD BEARING N11°16'59"E A DISTANCE OF 6.79 FEET, AND AN ARC DISTANCE OF 7.46 FEET TO A POINT ON THE SOUTHEASTERLY RIGHT-OF-WAY LINE OF LYRIC STREET AS SHOWN ON SAID RIDGEGATE SW VILLAGE FILING NO. 1;

THENCE ALONG SAID SOUTHEASTERLY RIGHT-OF-WAY LINE THE FOLLOWING THREE (3) COURSES:

1. THENCE ALONG THE ARC OF A CURVE TO THE LEFT, HAVING A CENTRAL ANGLE OF 09°14'54", A RADIUS OF 642.00 FEET, A CHORD BEARING N49°25'14"E A DISTANCE OF 103.51 FEET, AND AN ARC DISTANCE OF 103.63 FEET;
2. THENCE N47°30'39"E NON-TANGENT WITH THE LAST DESCRIBED CURVE A DISTANCE OF 213.09 FEET;
3. THENCE N42°13'12"E A DISTANCE OF 179.60 FEET TO THE WESTERLY CORNER OF TRACT BK AS SHOWN ON SAID RIDGEGATE SW VILLAGE FILING NO. 1;

THENCE ALONG THE SOUTHWESTERLY AND SOUTHEASTERLY LINES OF SAID TRACT BK THE FOLLOWING TWO (2) COURSES:

1. THENCE S50°19'35"E A DISTANCE OF 29.19 FEET;

2. THENCE N39°40'25"E A DISTANCE OF 30.81 FEET TO THE POINT OF BEGINNING.

CONTAINING 671,910 SQUARE FEET (15.425 ACRES), MORE OR LESS.

EXHIBIT B-8

**Legal Description of
Rampart Range Metropolitan District No. 8 Boundaries**

Lots 2-A-1, 2-A-2, and 2-A-4,
Ridgegate East Filing No. 1, 2nd Amendment
City of Lone Tree,
County of Douglas, State of Colorado.

AND

Lot 1,
Ridgegate East Filing No. 2,
as recorded in the real property records of Douglas County,
Colorado at Reception No. 2020097699.

AND

Lots 2 and 3, and Tracts A and B,
Ridgegate East Filing No. 4,
City of Lone Tree,
County of Douglas, State of Colorado.